



KODAMA

MICRO DRIFTER

INSTRUCTION MANUAL

Assembling Tools (Not Included in kit)

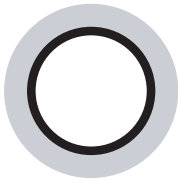

Double Side Tap

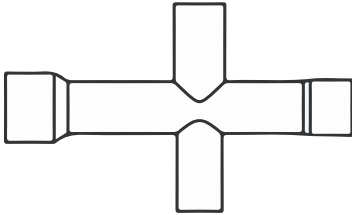

Nut Driver (4.0mm)

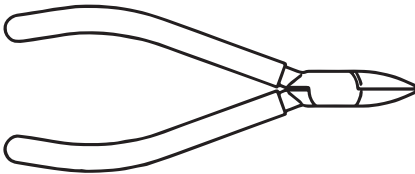

Side Cutter

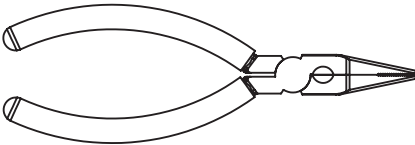

Needle-Nose Pliers



**Hex Wrench
(0.035 , 0.050 inch
and 1.5mm)**

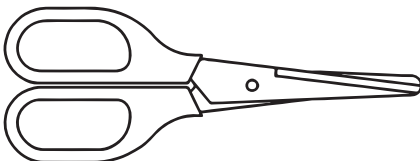

Scissors

1/28 Scale Manual

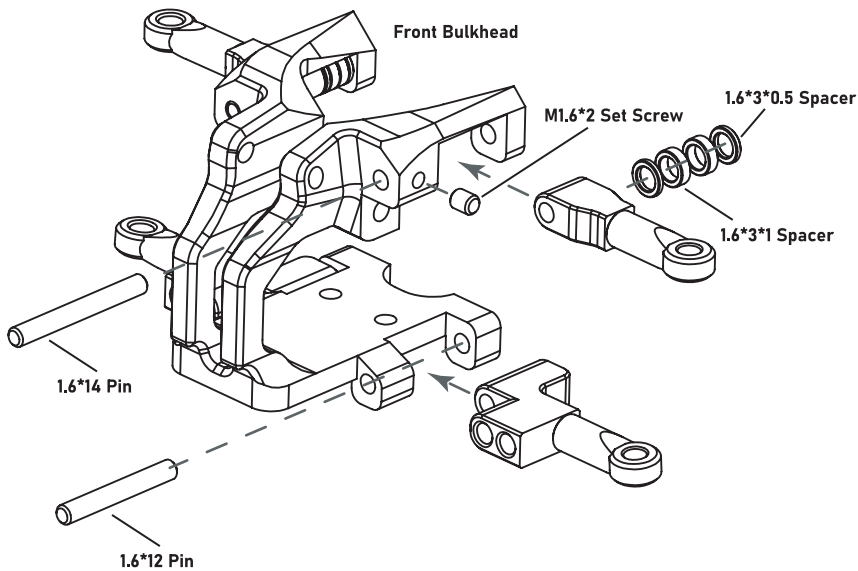
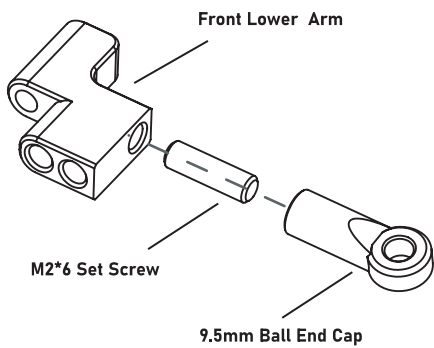
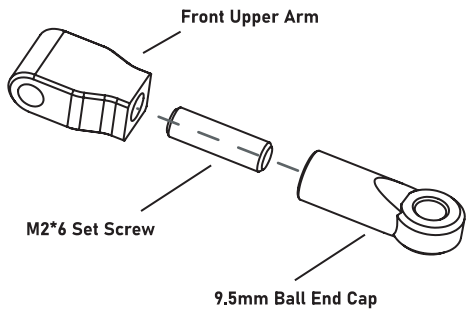

-  M1.6 x 2mm Set Screw (2)
-  M2 x 6mm Set Screw (4)
-  9.5mm Ball End Cap (4)
-  1.6 x 12mm Pin (2)
-  1.6 x 14mm Pin (2)
-  1.6 x 3 x 0.5mm Spacer (4)
-  1.6 x 3 x 1mm Spacer (4)

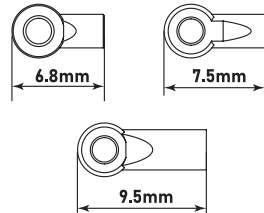

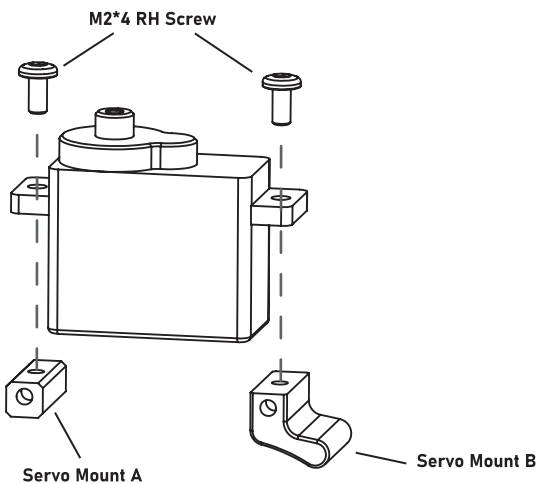

-  M2 x 4mm Round Head Screw (7)
-  M2 x 4mm Flat Head Screw (4)
-  2.5mm Ball 2.5mm Thread (2)

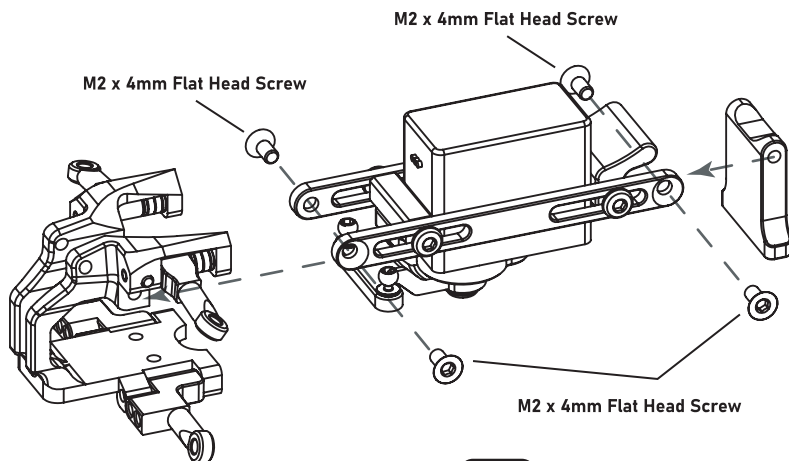
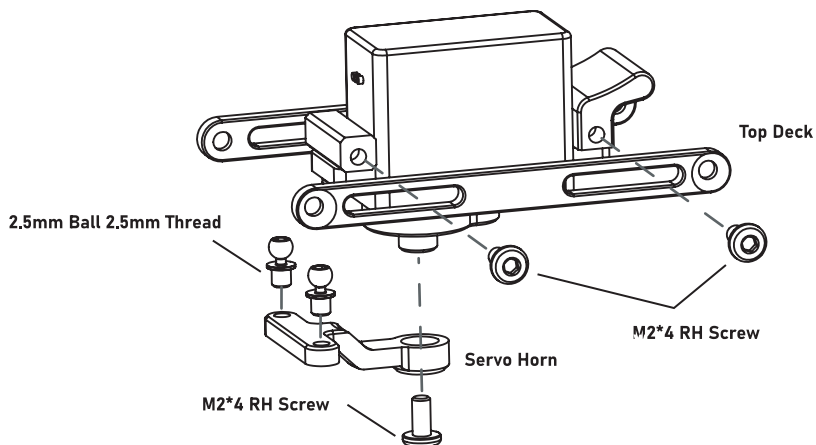



M2 x 4mm Round Head Screw (2)



M2 x 4mm Flat Head Screw (8)



2 x 6mm Alu Post (2)

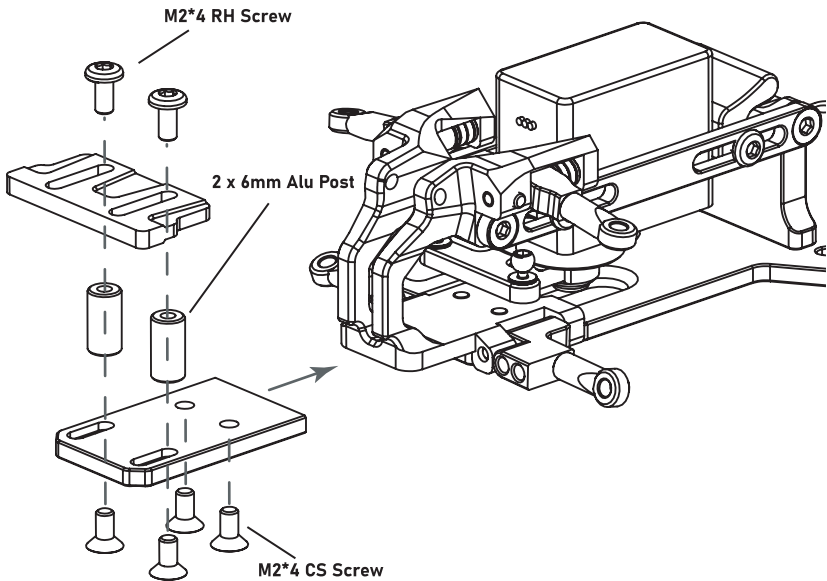
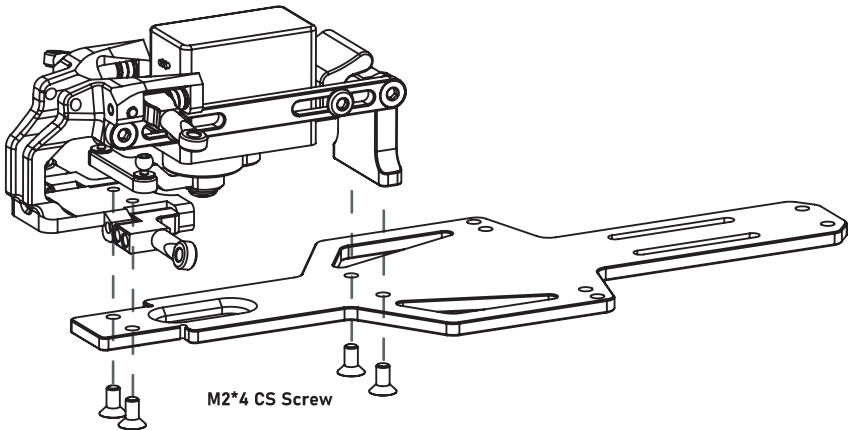



M2 x 4mm Round Head Screw (2)



2.5mm Ball 2.5mm Thread (6)







3 x 6 x 2 Bearing (4)

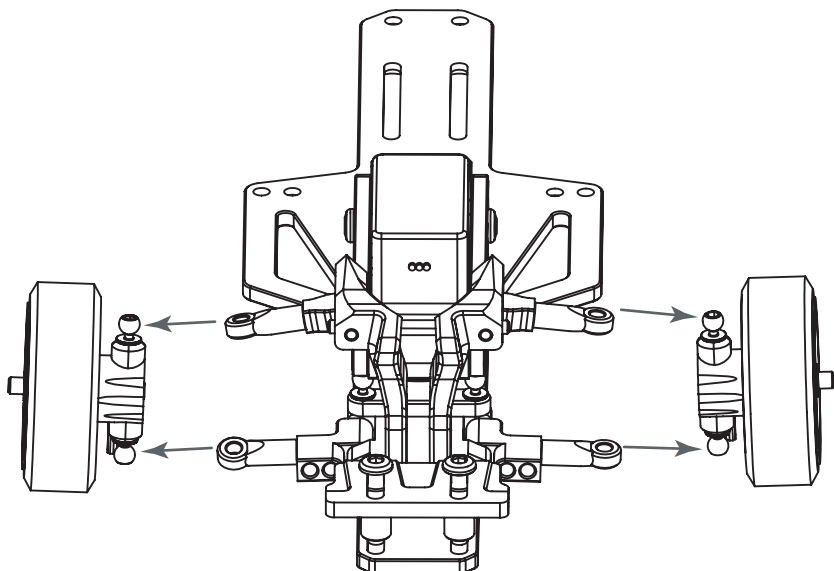
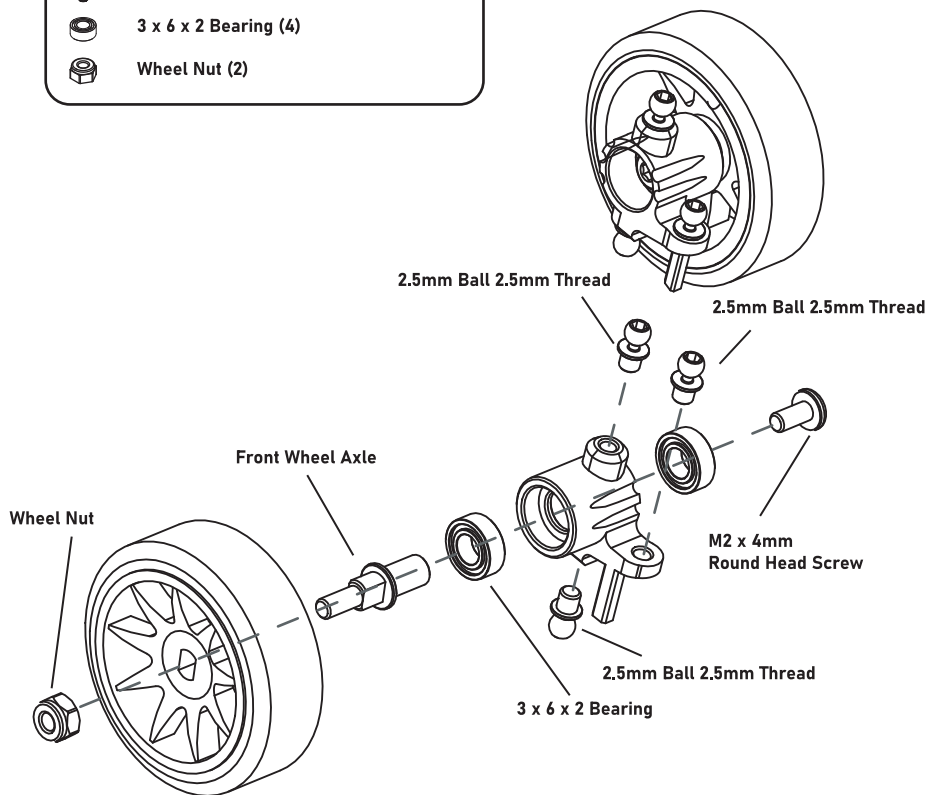

Wheel Nut (2)



-  M1.6 x 10mm Turnbuckle (2)
-  7.5mm Ball End Cap (2)
-  60° Ball End Cap (2)
-  2.5mm Ball 2.5mm Thread (2)

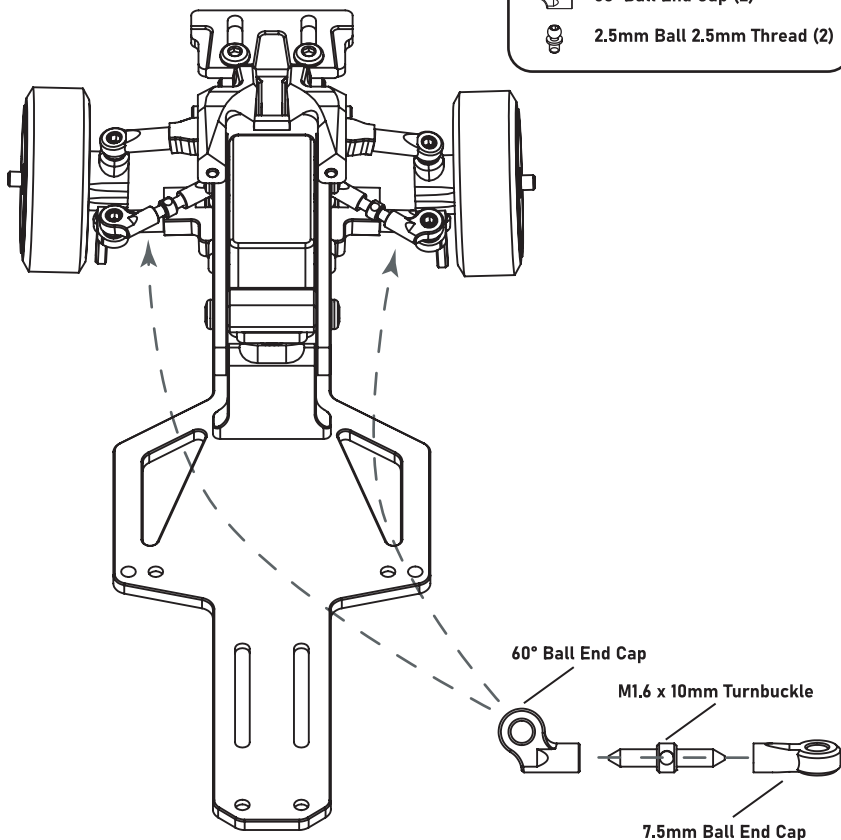

2.5mm Ball 2.5mm Thread

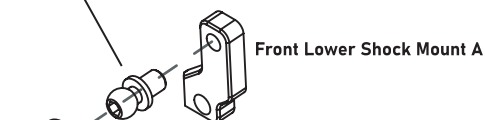

500-1000 Cst Oil
(Not Included)

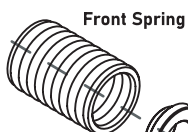

2.5mm Ball 2.5mm Thread

Front Lower Shock Mount B

Shock B





M2 x 4mm Round Head Screw (6)

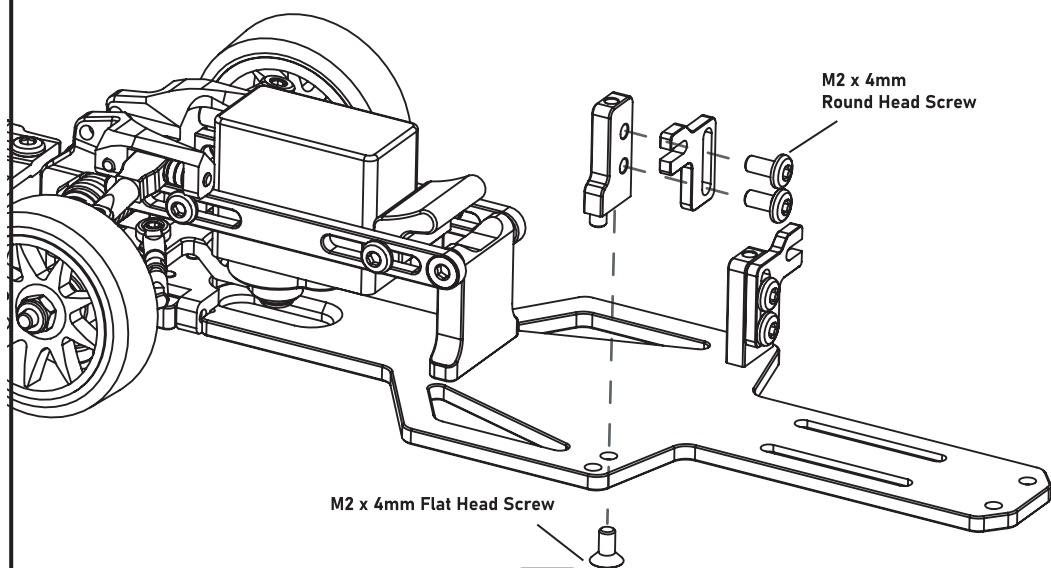
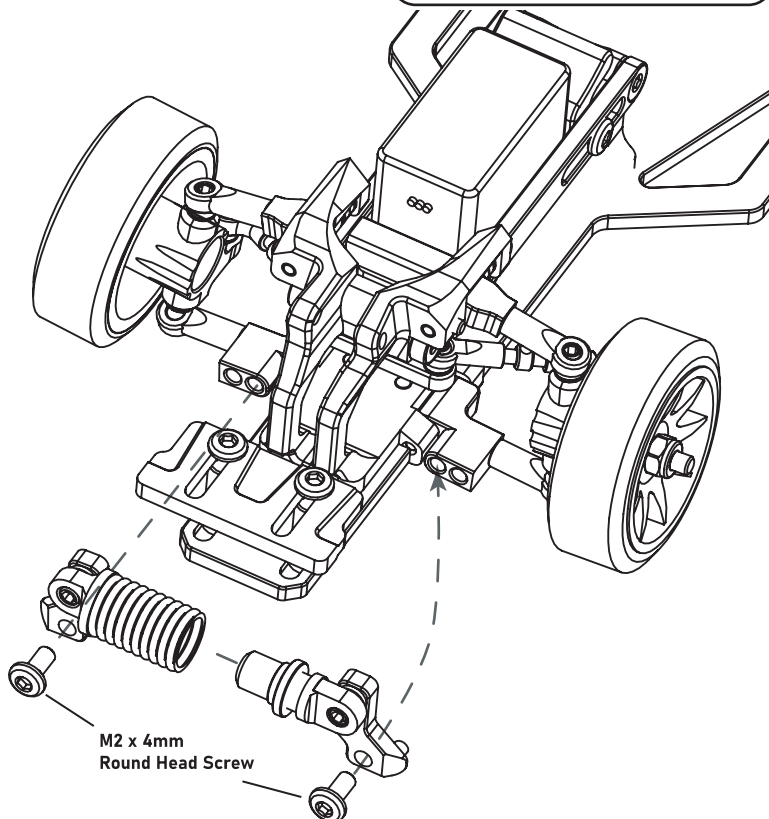

M2 x 4mm Flat Head Screw (2)



-  M2 x 4mm Flat Head Screw (2)
-  2.5mm Ball 2.5mm Thread (2)
-  Counter Shaft (1)

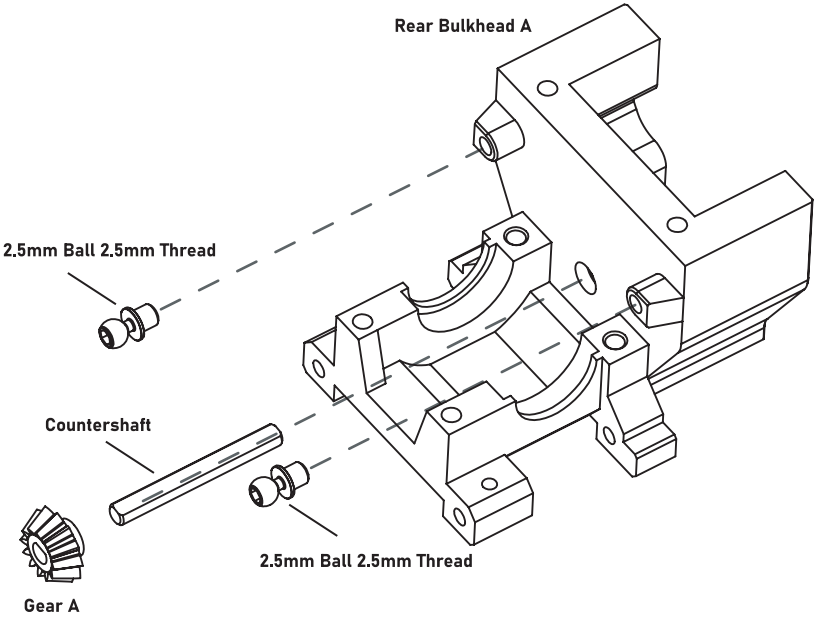
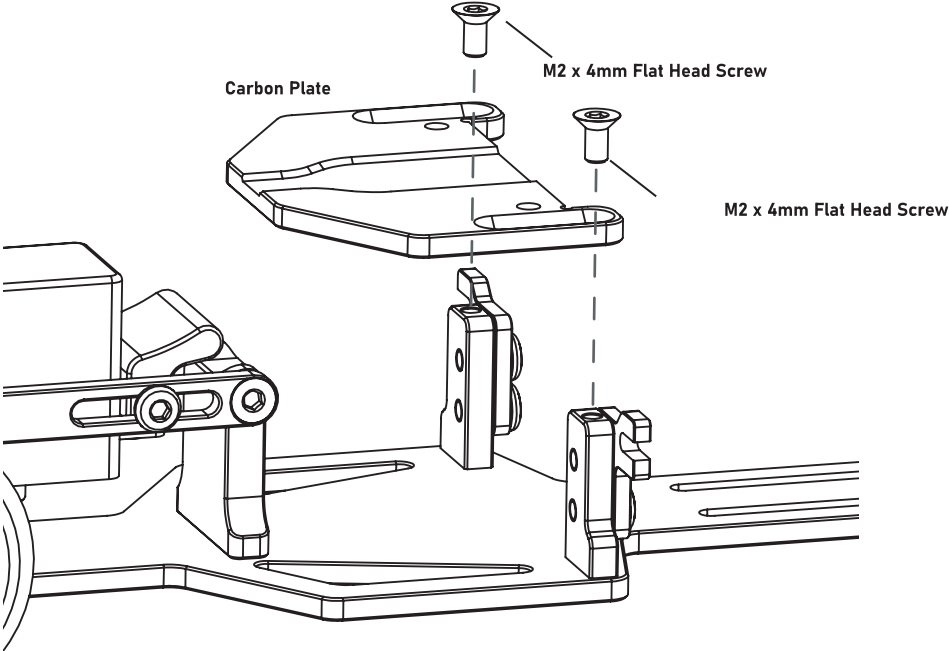



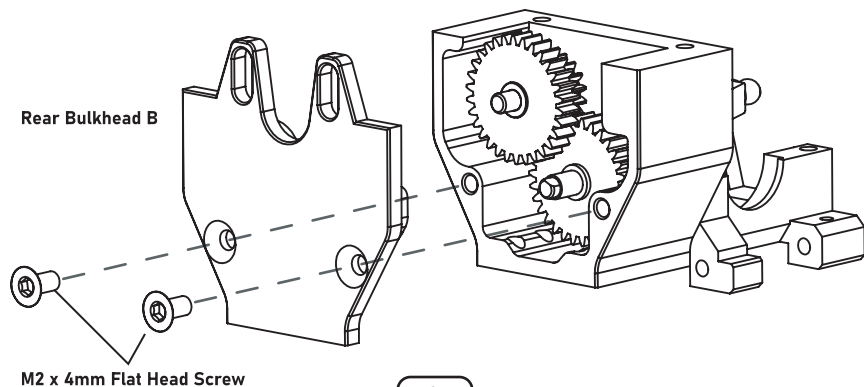
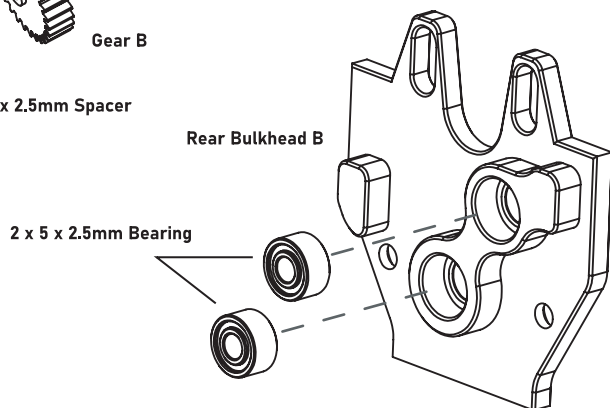
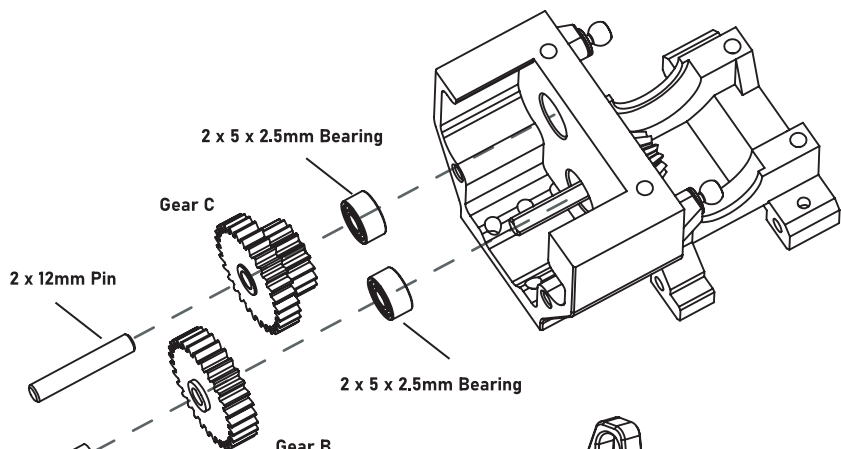



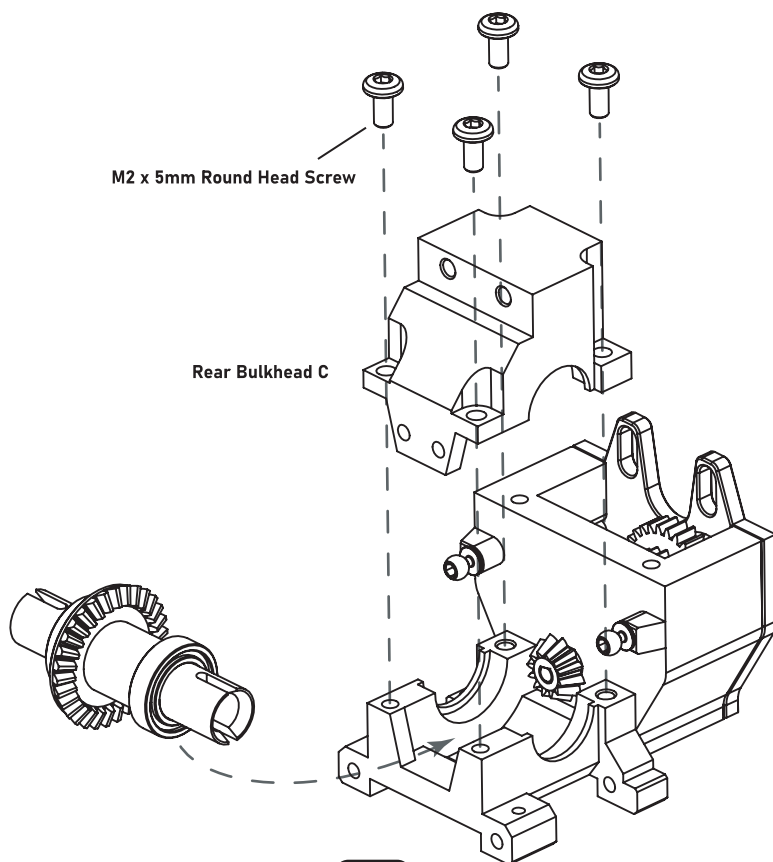
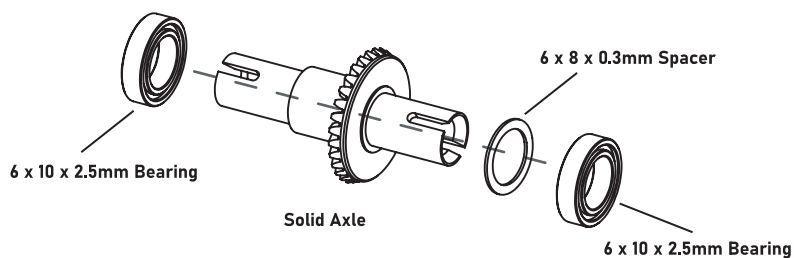

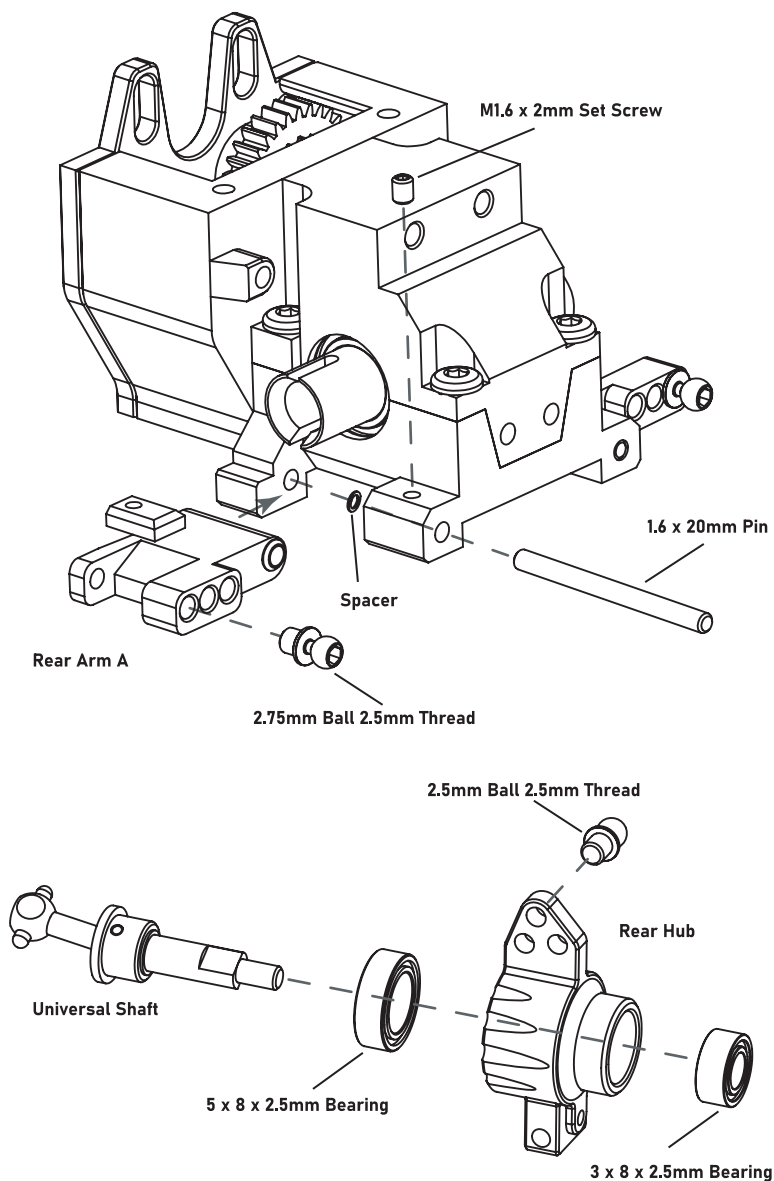
-  2 x 12mm Pin (1)
-  2 x 5 x 2.5mm Bearing (4)
-  2 x 3 x 2.5mm Spacer (1)
-  M2 x 4mm Flat Head Screw (2)



-  6 x 10 x 2.5mm Bearing (2)
-  6 x 8 x 0.3mm Spacer (1)
-  M2 x 5mm Round Head Screw (4)





- | | |
|---|--|
|  M1.6 x 2mm Flat Head Screw (2) |  6.8mm Ball End Cap (4) |
|  M2 x 4mm Round Head Screw (6) |  M1.6 x 5mm Set Screw (2) |
|  M2 x 4mm Flat Head Screw (2) |  M2 x 2.5mm Bushing (2) |
|  1.6 x 10mm Pin (2) |  2.75mm Ball 2.5mm Thread (2) |

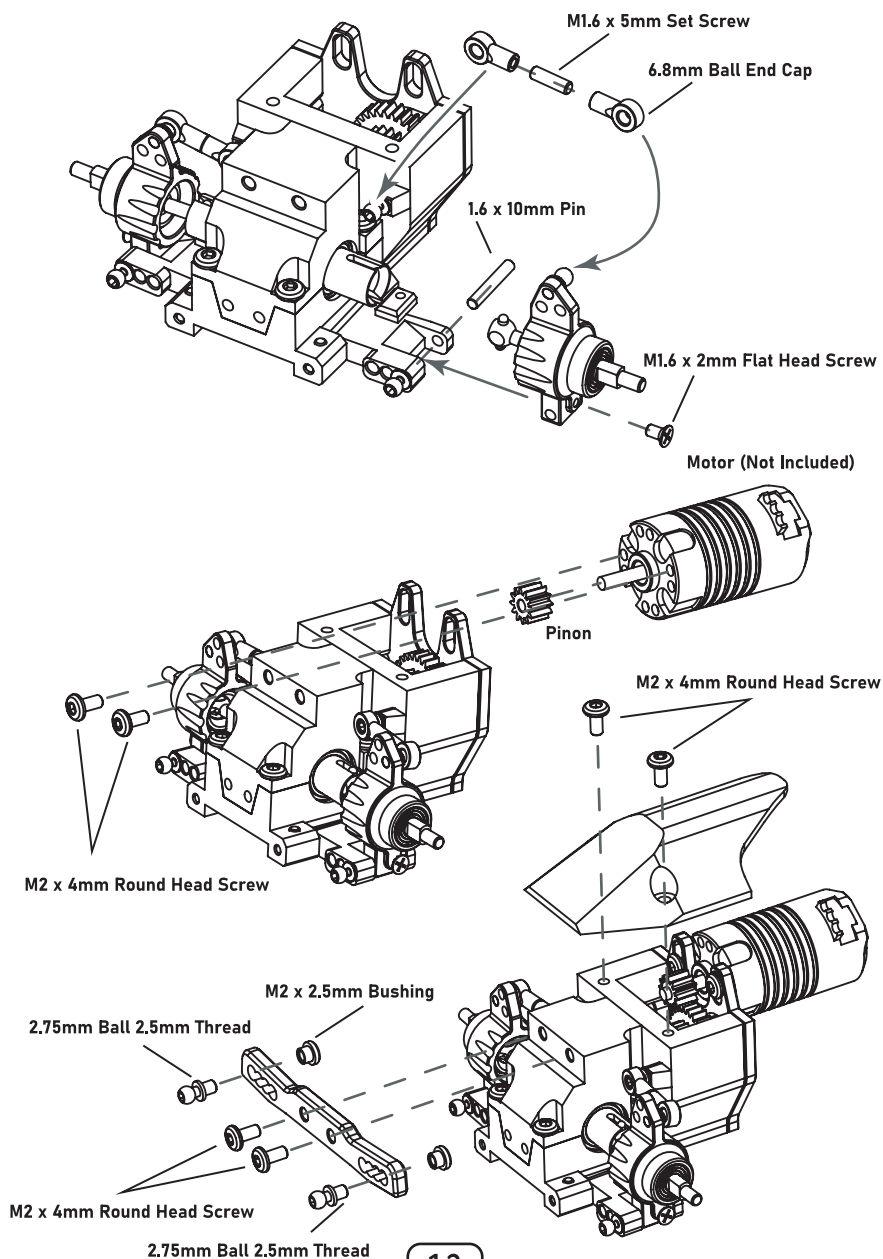



M2 x 3mm Round Head Screw (2)



M2 x 4mm Flat Head Screw (2)

Rear Shock A



Adjust Nut



Rear Spring

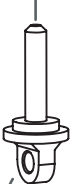

Rear Shock B

500-1000 Cst Oil
(Not Included)

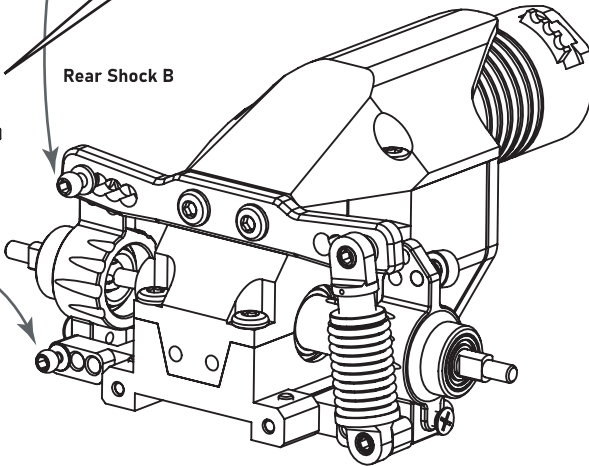

M2 x 3mm Round Head Screw

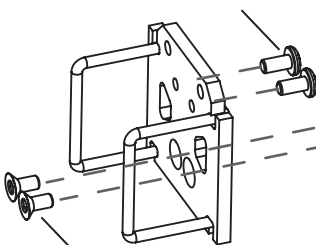

M2 x 4mm Flat Head Screw



Wheel Nut (2)



M2 x 4mm Flat Head Screw (2)

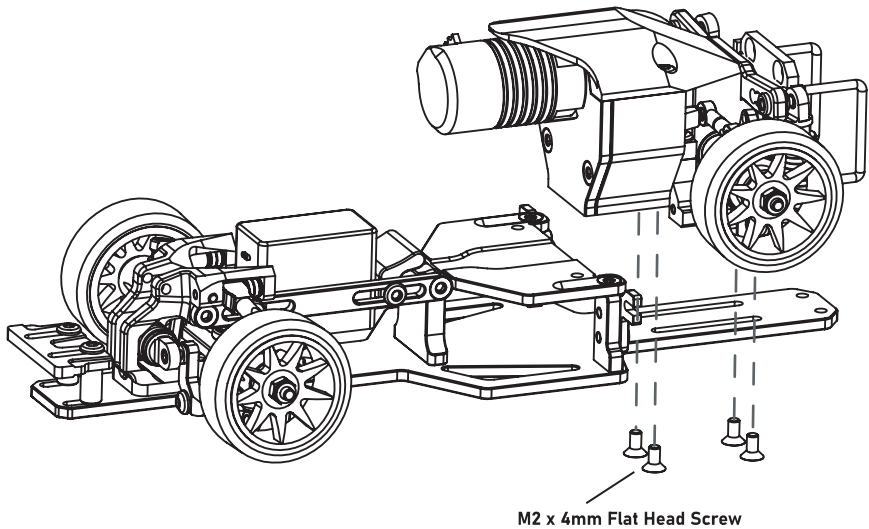
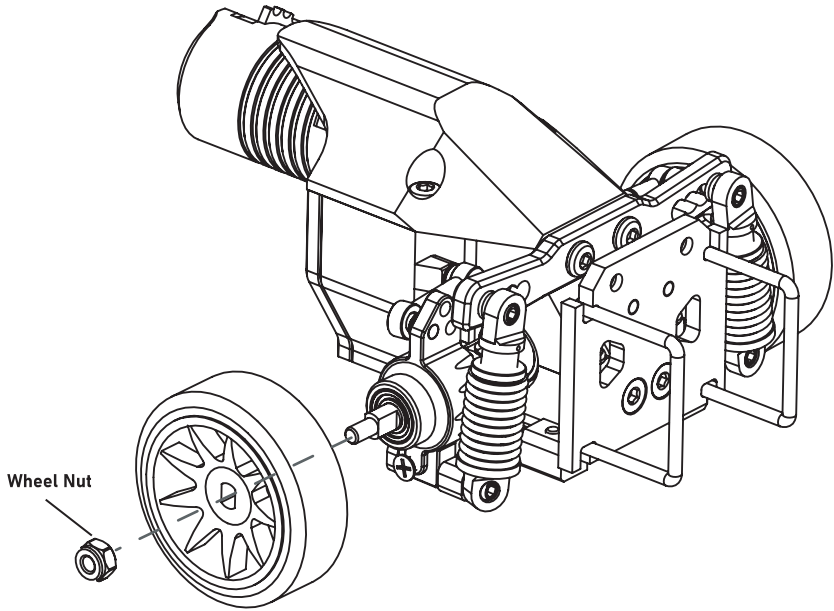

1/28 Scale Assembly Completion Diagram

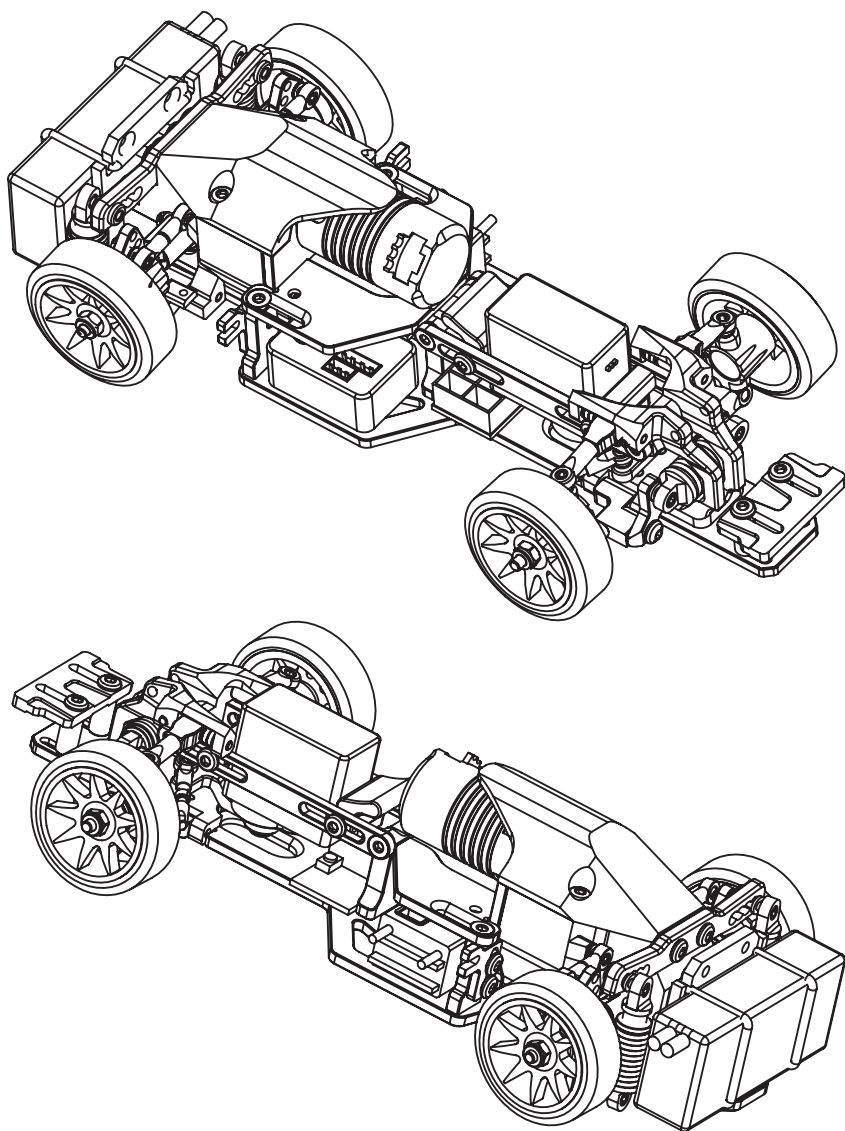

1/24 Scale Manual

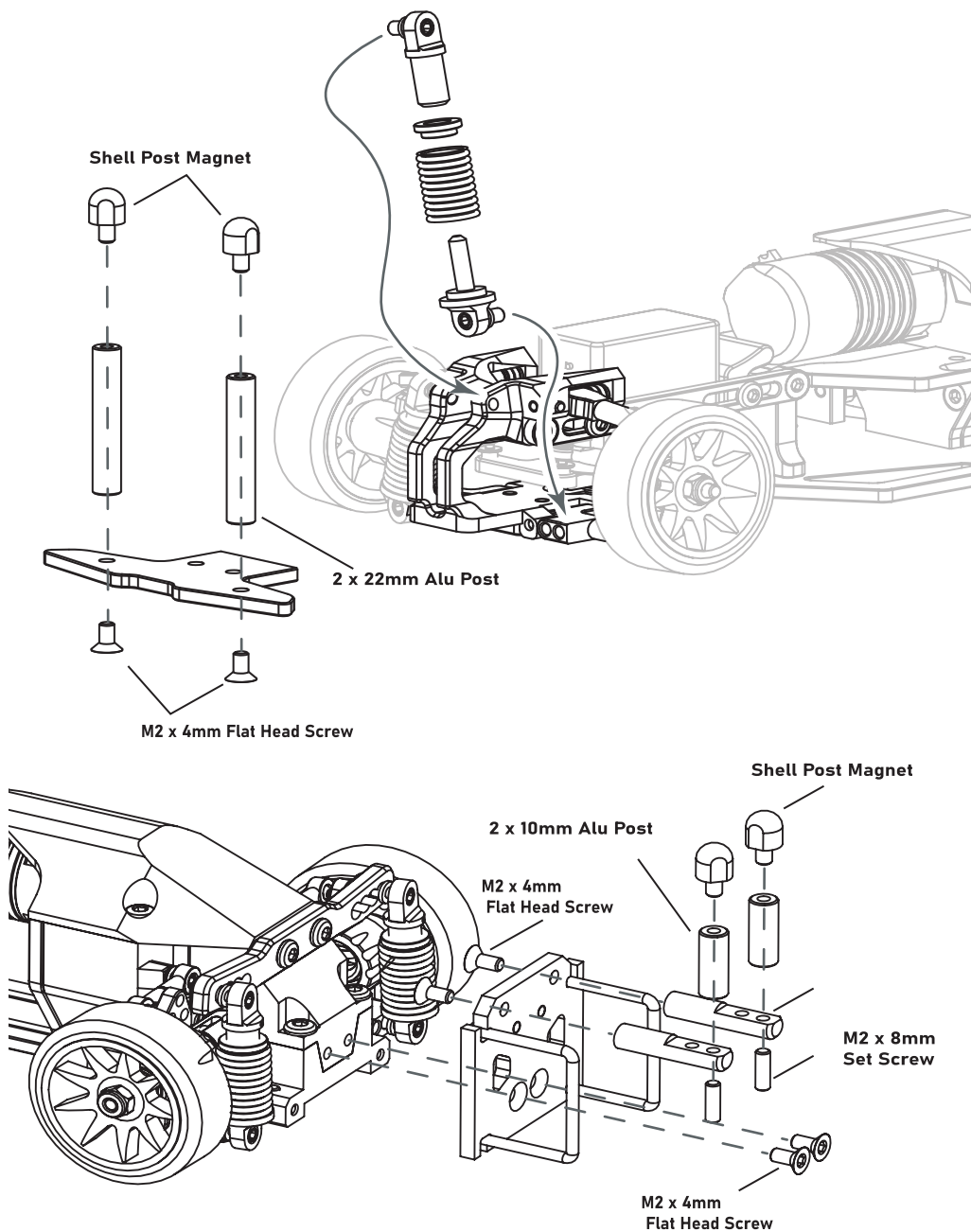

1/24 Scale Manual

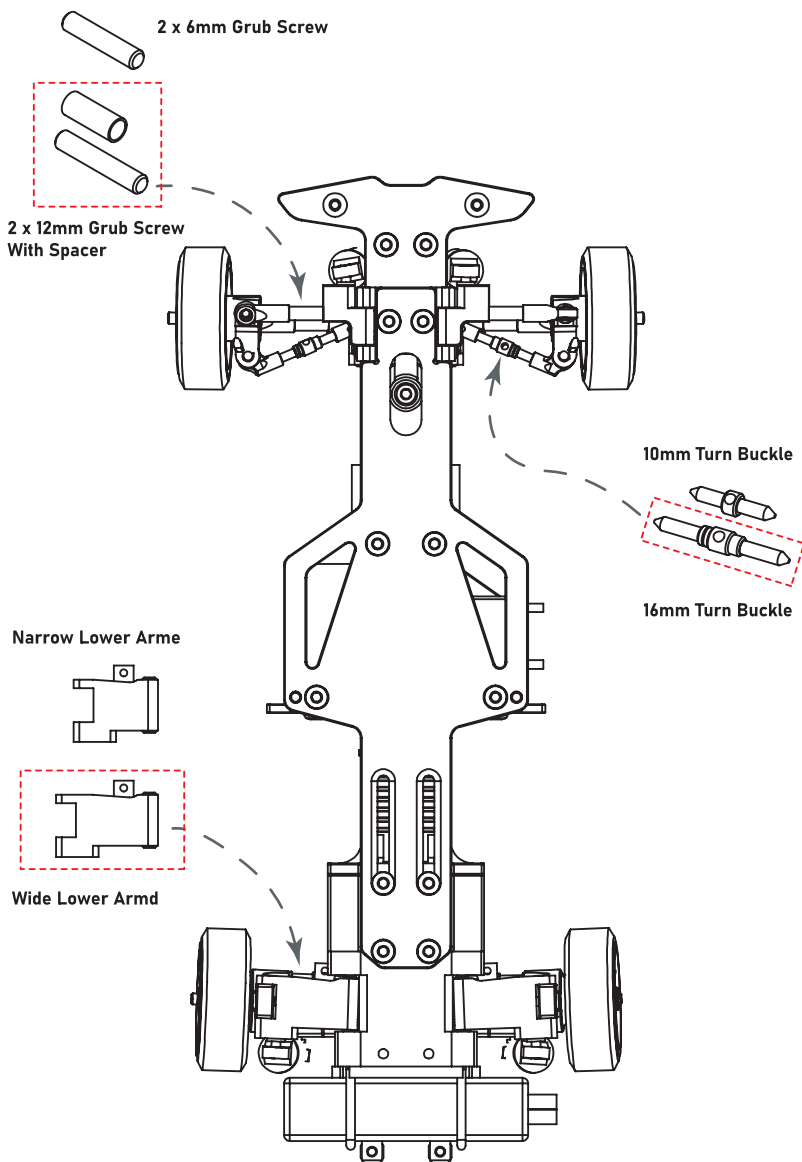

1/24 Scale Manual

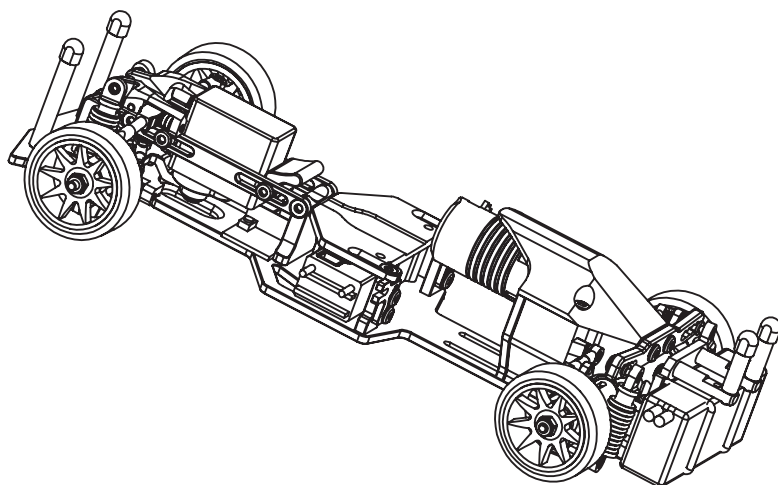
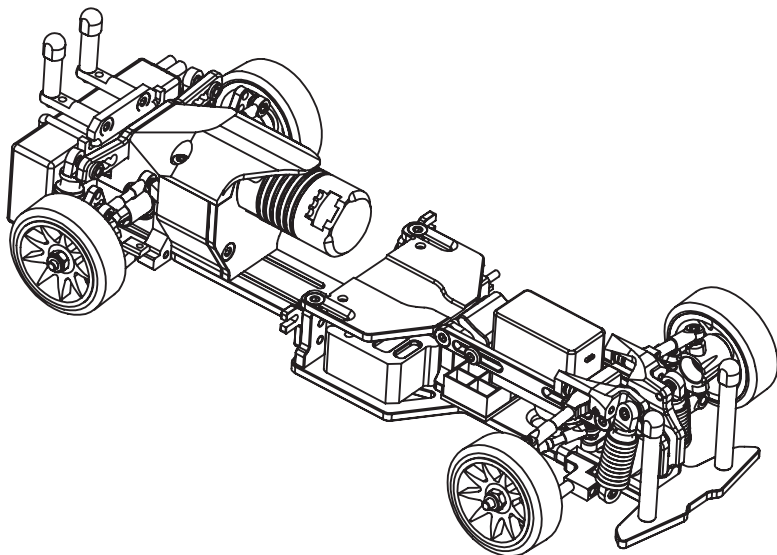



冠
式

O N I S I K I