

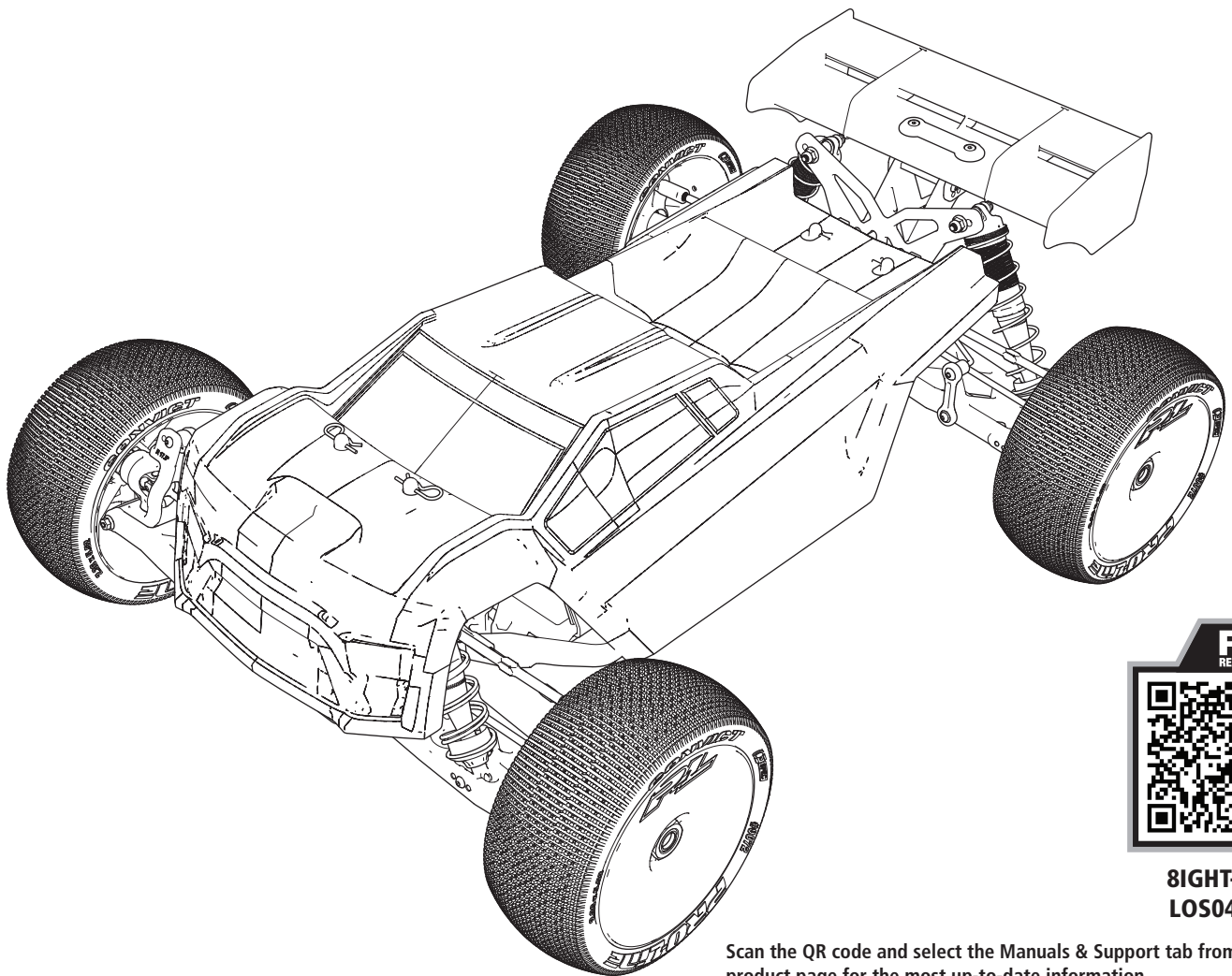

# 8IGHT-XTE™

1/8-SCALE HIGH-PERFORMANCE 4WD ELECTRIC TUGGY RTR



**RTR**  
READY-TO-RUN  
**8IGHT-XTE**  
**LOS04020**

Scan the QR code and select the Manuals & Support tab from the product page for the most up-to-date information.

Scannen Sie den QR-Code und wählen Sie auf der Produktseite die Registerkarte Handbücher und Unterstützung, um die aktuellsten Informationen zu erhalten.

Scannez le code QR et sélectionnez l'onglet Manuals and Support sur la page du produit pour obtenir les informations les plus récentes.

Scannerizzare il codice QR e selezionare la scheda Manuali e Supporto dalla pagina del prodotto per le informazioni più aggiornate.

**INSTRUCTION MANUAL**  
**BEDIENUNGSANLEITUNG**  
**MANUEL D'UTILISATION**  
**MANUALE DI ISTRUZIONI**

648789  
Created 3/24

Before operating this vehicle, please read all printed materials thoroughly. Horizon Hobby is not responsible for inadvertent errors in this manual.

**HORIZON**  
H O B B Y

**NOTICE**

All instructions, warranties and other collateral documents are subject to change at the sole discretion of Horizon Hobby, LLC. For up-to-date product literature, visit horizonhobby.com and click on the support tab for this product.

**MEANING OF SPECIAL LANGUAGE**

The following terms are used throughout the product literature to indicate various levels of potential harm when operating this product:

**WARNING:** Procedures, which if not properly followed, create the probability of property damage, collateral damage, and serious injury OR create a high probability of superficial injury.

**CAUTION:** Procedures, which if not properly followed, create the probability of physical property damage AND a possibility of serious injury.

**NOTICE:** Procedures, which if not properly followed, create a possibility of physical property damage AND a little or no possibility of injury.

 **WARNING:** Read the ENTIRE instruction manual to become familiar with the features of the product before operating. Failure to operate the product correctly can result in damage to the product, personal property and cause serious injury.

This is a sophisticated hobby product. It must be operated with caution and common sense and requires some basic mechanical ability. Failure to operate this Product in a safe and responsible manner could result in injury or damage to the product or other property. This product is not intended for use by children without direct adult supervision. Do not use with incompatible components or alter this product in any way outside of the instructions provided by Horizon Hobby, LLC. This manual contains instructions for

safety, operation and maintenance. It is essential to read and follow all the instructions and warnings in the manual, prior to assembly, setup or use, in order to operate correctly and avoid damage or serious injury.

 **WARNING AGAINST COUNTERFEIT PRODUCTS**

Always purchase from a Horizon Hobby authorized dealer to ensure authentic high-quality Spektrum product. Horizon Hobby, LLC disclaims all support and warranty with regards, but not limited to, compatibility and performance of counterfeit products or products claiming compatibility with DSM or Spektrum technology.

**Age Recommendation: Not for children under 14 years. This is not a toy.**

**SAFETY PRECAUTIONS AND WARNINGS**

- Always keep a safe distance in all directions around your model to avoid collisions or injury. This model is controlled by a radio signal subject to interference from many sources outside your control. Interference can cause momentary loss of control.
- Always operate your model in open spaces away from full-size vehicles, traffic and people.
- Always carefully follow the directions and warnings for this and any optional support equipment (chargers, rechargeable battery packs, etc.).

- Always keep all chemicals, small parts and anything electrical out of the reach of children.
- Always avoid water exposure to all equipment not specifically designed and protected for this purpose. Moisture causes damage to electronics.
- Never place any portion of the model in your mouth as it could cause serious injury or even death.
- Never operate your model with low transmitter batteries.

**TABLE OF CONTENTS**

Water-resistant Vehicle with Waterproof Electronics.....	3
Quick Start.....	3
Spektrum DX3 Radio System .....	4
Transmitter Battery Installation .....	4
SR315 Receiver .....	4
Receiver Antenna .....	4
Binding the receiver.....	4
Powering on the Vehicle .....	5
Operation.....	5
Control Test.....	5
Before Running Your Vehicle .....	5
Driving Precautions .....	5
Run Time.....	5
Spektrum™ Firma™ SMART 130A Brushless ESC (SPMXSE2130S) .....	6
Body Painting Procedure.....	6
Spektrum™ Firma™ 2250KV 4-pole Brushless Motor.....	8
Run Time.....	8
Vehicle Maintenance .....	9
Shock Disassembly/Cleaning.....	9
Refilling/Bleeding Shocks.....	9
Tuning, Adjusting & Maintaining Your Vehicle .....	10
Changing the Travel Adjust Settings .....	10
Service/Repair .....	10
Troubleshooting Guide .....	10
Warranty and Service Contact Information .....	12
FCC Information.....	12
IC Information.....	12
Compliance Information for the European Union.....	12
Exploded View .....	46
Replacement Parts .....	50
Recommended Parts .....	53
Optional Parts .....	54

**REGISTER YOUR LOSI PRODUCT ONLINE**

Register your vehicle now and be the first to find out about the latest option parts, product updates and more. Click on the Support tab at WWW.LOSI.COM and follow the product registration link to stay connected.

**TOOLS NEEDED**

- Needle-nose pliers
- Quality .050, 1.5mm, 2.0mm, 2.5mm hex (Allen) drivers

**TOOLS INCLUDED**

- 4 Way wrench
- Three (3) hex "L" wrench set: .1.5, 2.0, and 2.5
- Shock Bottom wrench

**NEEDED TO COMPLETE**

- Battery: Spektrum 14.8V 5000mAh 4S 50C Smart Hardcase LiPo Battery: IC5® (SPMX50004S50H5) or Spektrum 14.8V 5000mAh 4S 100C Smart G2 Hardcase LiPo Battery: IC5 (SPMX54S100H5)
- Charger: Spektrum® S1100 G2 1x100W AC Smart Charger (SPMXC2080)
- RC Polycarbonate Body Paint

Use only Dynamite® tools or other high-quality tools. Use of inexpensive tools can cause damage to the small screws and parts used on this type of model.

BOX CONTENTS	INCLUDED COMPONENTS	REQUIRED, NOT INCLUDED	RECOMMENDED SKU
Losi® 8IGHT-XTE RTR (LOS)	Spektrum™ DX3™ SMART Transmitter (SPMR2340)	50C or Higher 4S Hardcase LiPo with IC5	Spektrum 14.8V 5000mAh 4S 50C Smart Hardcase LiPo Battery: IC5®: (SPMX50004S50H5)
	Spektrum SR315 3 Channel Telemetry Surface Receiver (SPMSR315)		Spektrum 14.8V 5000mAh 4S 100C Smart G2 Hardcase LiPo Battery: IC5 (SPMX54S100H5)
	Spektrum S665 Waterproof Servo (SPMS665)		
	Spektrum Firma™ SMART 130A Brushless ESC (SPMXSE2130S)	2S-4S Lipo Charger	Spektrum S1200 G2 AC 1x200@ Smart Charger (SPMXC2020)
	Spektrum Firma 2250Kv 4-Pole Brushless Motor (SPMXSM4300)		
	4 AA batteries (for transmitter)		
	8IGHT-XTE Unpainted Body		

### Spektrum Smart Technology

The 8IGHT-XTE includes Spektrum Smart Technology in the ESC and receiver, which can provide you with telemetry information like battery voltage from your vehicle. The included DX3 Smart transmitter features an LED display to show the battery level of your vehicle during operation.

For additional Smart functionality, consider upgrading to a more advanced

Smart Technology compatible Spektrum transmitter like the DX5C (SPMR5115-transmitter only), or DX5 Pro (SPMR5025-transmitter only). Use Spektrum Smart batteries to power your 8IGHT-XTE to take full advantage of Smart Technology, which can communicate detailed battery data through the system as well. Visit [www.SpektrumRC.com](http://www.SpektrumRC.com) for more information.

## WATER-RESISTANT VEHICLE WITH WATERPROOF ELECTRONICS

Your new Horizon Hobby vehicle has been designed and built with a combination of waterproof and water-resistant components to allow you to operate the product in many "wet conditions," including puddles, creeks, wet grass, snow and even rain.

While the entire vehicle is highly water-resistant, it is not completely waterproof and your vehicle should NOT be treated like a submarine. The various electronic components used in the vehicle, such as the Electronic Speed Control (ESC), servo(s) and receiver are waterproof, however, most of the mechanical components are water-resistant and should not be submerged.

Metal parts, including the bearings, hinge pins, screws and nuts, as well as the contacts in the electrical cables, will be susceptible to corrosion if additional maintenance is not performed after running in wet conditions. To maximize the long-term performance of your vehicle and to keep the warranty intact, the procedures described in the "Wet Conditions Maintenance" section below must be performed regularly if you choose to run in wet conditions. If you are not willing to perform the additional care and maintenance required, then you should not operate the vehicle in those conditions.



**CAUTION:** Failure to exercise caution while using this product and complying with the following precautions could result in product malfunction and/or void the warranty.

### GENERAL PRECAUTIONS

- Read through the wet conditions maintenance procedures and make sure that you have all the tools you will need to properly maintain your vehicle.
- Not all batteries can be used in wet conditions. Consult the battery manufacturer before use. Caution should be taken when using Li-Po batteries in wet conditions.
- Most transmitters are not water-resistant. Consult your transmitter's manual or the manufacturer before operation.
- Never operate your transmitter or vehicle where lightning may be present.
- Do not operate your vehicle where it could come in contact with salt water (ocean water or water on salt-covered roads), contaminated or polluted water. Salt water is very conductive and highly corrosive, so use caution.
- Even minimal water contact can reduce the life of your motor if it has not been certified as water-resistant or waterproof. If the motor becomes excessively wet, apply very light throttle until the water is mostly removed from the motor.

Running a wet motor at high speeds may rapidly damage the motor.

- Driving in wet conditions can reduce the life of the motor. The additional resistance of operating in water causes excess strain. Alter the gear ratio by using a smaller pinion or larger spur gear. This will increase torque (and motor life) when running in mud, deeper puddles, or any wet conditions that will increase the load on the motor for an extended period of time.

### WET CONDITIONS MAINTENANCE

- Drain any water that has collected in the tires by spinning them at high speed. With the body removed, place the vehicle upside down and pull full throttle for a few short bursts until the water has been removed.



**CAUTION:** Always keep hands, fingers, tools and any loose or hanging objects away from rotating parts when performing the above drying technique.

- Remove the battery pack(s) and dry the contacts. If you have an air compressor or a can of compressed air, blow out any water that may be inside the recessed connector housing.
- Remove the tires/wheels from the vehicle and gently rinse the mud and dirt off with a garden hose. Avoid rinsing the bearings and transmission.

**NOTICE:** Never use a pressure washer to clean your vehicle.

- Use an air compressor or a can of compressed air to dry the vehicle and help remove any water that may have gotten into small crevices or corners.
- Spray the bearings, drive train, fasteners and other metal parts with a water-displacing light oil. Do not spray the motor.
- Let the vehicle air dry before you store it. Water (and oil) may continue to drip for a few hours.
- Increase the frequency of disassembly, inspection and lubrication of the following:
  - Front and rear axle hub assembly bearings.
  - All transmission cases, gears and differentials.
  - Motor—clean with an aerosol motor cleaner and re-oil the bushings with lightweight motor oil.

## QUICK START

Please read the entire manual to gain a full understanding of the 8IGHT-XTE™ RTR Truggy, fine-tuning the setup and performing maintenance.

1. Read the safety precautions found in this manual.
2. Charge the battery pack you have chosen (NOT INCLUDED). Refer to the Manufacturer's Supplied instructions for battery charging information.
3. Install the AA batteries in the transmitter. Only use alkaline or rechargeable batteries.
4. Install a fully charged battery in the vehicle.
5. Power ON the transmitter and then the vehicle. Always power the transmitter ON before the vehicle and power it OFF after the vehicle has been powered OFF.
6. Check the steering and throttle control directions. Verify that the servo is moving in the correct direction.
7. Drive your vehicle.
8. Perform any necessary maintenance.

## SPEKTRUM DX3 RADIO SYSTEM

For more information on the transmitter, go to [www.horizonhobby.com](http://www.horizonhobby.com) and click on the support tab for the Spektrum DX3 to download the instruction manual.

### A/B. Channel 3 Button

#### C. Throttle/Brake

#### D. Steering Wheel

#### E. Steering Rate

Adjusts the end point of the steering

#### F. Brake Rate

Adjusts the braking end point.

#### G. Steering Trim

Adjusts the steering center point. Normally, the steering trim is adjusted until the vehicle tracks straight.

#### H. Throttle Trim

Adjusts the throttle neutral point

#### I. SMART Battery Level Indicator

#### J. Servo Reversing

To reverse the Throttle (TH) or Steering (ST) channel, switch the position of the correlating switch—"N" is for normal, "R" is for reverse.

#### Throttle Limit

- K. Limits throttle output to 50/75/100%  
Select 50% or 75% for less experienced drivers or when you are driving the vehicle in a small area.

#### L. Power LED

- **Solid red lights:** Indicates radio connectivity and adequate battery power
- **Flashing red lights:** Indicates the battery voltage is critically low. Replace batteries

#### M. Power Button

#### N. Bind Button

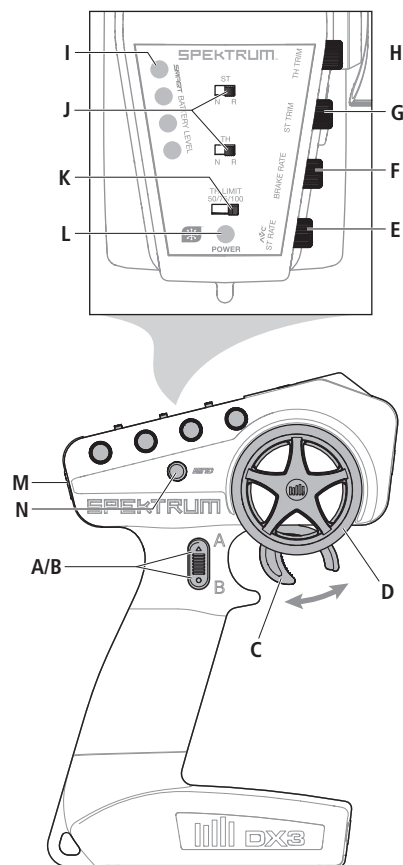

## TRANSMITTER BATTERY INSTALLATION

This transmitter requires 4 AA batteries

1. Remove the battery cover from the transmitter.
2. Install the batteries as shown.
3. Install the battery cover.

**CAUTION:** Never remove the transmitter batteries while the model is powered ON. Loss of model control, damage, or injury may occur.

**CAUTION:** If using rechargeable batteries, charge only rechargeable batteries. Charging non-rechargeable batteries may cause the batteries to burst, resulting in injury to persons and/or damage to property.

**CAUTION:** Risk of explosion if battery is replaced by an incorrect type. Dispose of used batteries according to national regulations.

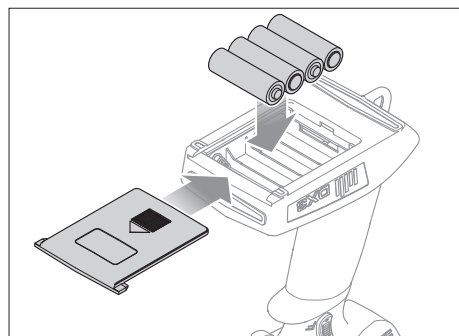

## SR315 RECEIVER

### Specifications

**Type:** Dual Protocol 3 Ch Receiver (SLT/DSMR)

**Dimensions (LxWxH):** 32.5 x 21.5 x 12.4mm

**Antenna Length:** 90mm

**Channels:** 3

**Weight:** 6g

**Band:** 2.4GHz

**Voltage Range:** 3.5–9.6V

**Bind Type:** Bind Button

**Failsafe:** Hold the steering wheel and throttle trigger in the desired failsafe positions during binding

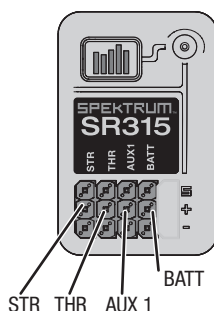

## RECEIVER ANTENNA

The SR315 receivers feature a coaxial antenna design for easy installation in almost any model. Think of the last 1 inch (32mm) on the tip of the antenna as the active portion of the antenna, the coaxial portion leading up to it is just an extension. Install the antenna so the active portion is positioned as high as possible in the vehicle, and not "in the shadow" of any carbon fiber or metal. The case of the receiver can accept an antenna tube directly, making optimal antenna placement easy (antenna tube not included).

**WARNING:** Do not kink, cut or damage the antenna wire. The antenna is made of a coaxial wire; if the outer sheath becomes damaged, the receiver will not work properly. If the antenna is damaged in any way, replace the antenna before attempting to use the receiver.

## BINDING THE RECEIVER

Binding is the process of programming the receiver to recognize the GUID (Globally Unique Identifier) code of a single specific transmitter. In the event of a loss of signal the receiver will default the servo outputs to the failsafe position. The failsafe positions are set during binding; Leave the throttle and steering at the neutral positions during binding.

1. Press and hold the bind button, and Power ON the receiver; the orange LED will begin to flash.
2. Set the trims and control positions at the desired failsafe settings, press and hold the bind button, and power ON the DX3 Smart transmitter.
3. When the orange LED on the DX3 Smart transmitter remains lit, it is connected to SR315 receiver.

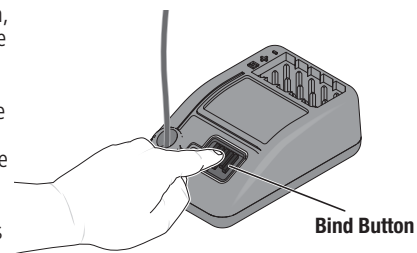

You must rebind when:

- Different failsafe positions are desired e.g., when throttle or steering reversing has been changed.
- Binding the receiver to a different transmitter.

## POWERING ON THE VEHICLE

1. Center the ST TRIM and TH TRIM dials on the transmitter.
2. Power on the transmitter.
3. Remove the body from the vehicle.
4. Connect a fully charged battery pack to the ESC.
5. Power on the ESC.

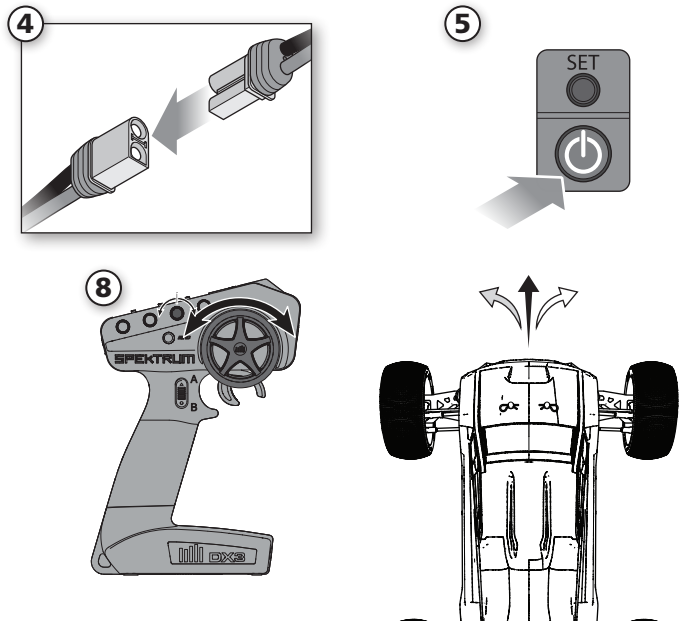
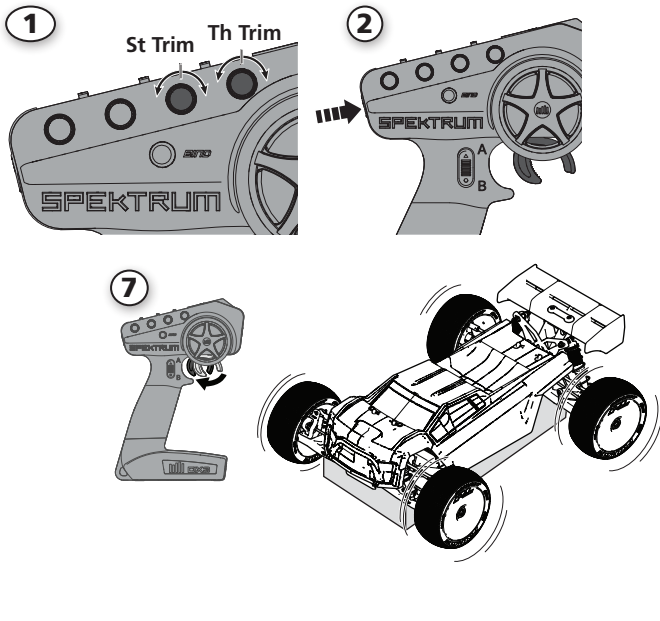

## OPERATION

- **ALWAYS** turn on your transmitter before you turn on the receiver in the vehicle. Always power off the receiver before turning your transmitter off.
- **ALWAYS** operate your vehicle in a wide open area. Operating the vehicle in a small space or indoors can cause overheating at low speeds. Operating at low speed increases heat in the electronic speed control (ESC). Overheating can damage the vehicle and failure may result.

## CONTROL TEST

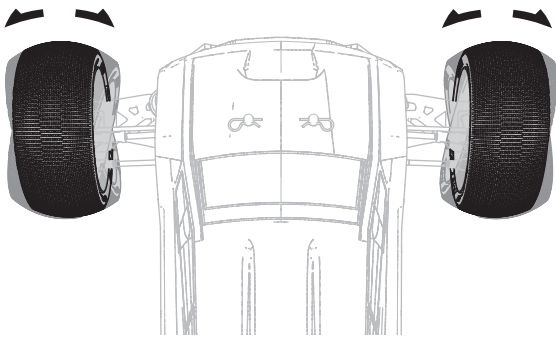

Perform a control test with the vehicle wheels off the ground. If the wheels rotate after the vehicle is powered ON, adjust the TH TRIM knob until they stop. To make the wheels move forward, pull the trigger. To reverse them, wait for the wheels to stop, then push the trigger. When moving forward, the wheels should maintain a straight line without any steering wheel input. If not, adjust the ST TRIM knob so the wheels maintain a straight line without having to turn the steering wheel.

## BEFORE RUNNING YOUR VEHICLE

1. Break in the differentials. While holding the chassis with only the left side tires firmly on the ground, give the car about 1/8 throttle for 30 seconds. The right side tires should spin freely during this time. Repeat this with only the right side tires firmly on the ground, allowing the left side tires to spin freely. Repeat this 2–3 times.
2. Check for free suspension movement. All suspension arms and steering components should move freely. Any binds will cause the car to handle poorly.
3. Charge the battery.
4. Check the calibration of the ESC. If recalibration is required, refer to the **130A Sensored Brushless ESC** section.
5. Adjust the transmitter settings to your desired configuration.

## DRIVING PRECAUTIONS

- Maintain sight of the vehicle at all times.
- Inspect the vehicle for loose wheel hardware.
- Inspect the steering assembly for any loose hardware. Driving the vehicle off-road can cause fasteners to loosen over time.
- Do not drive the vehicle in tall grass. Doing so can damage the vehicle or electronics.
- Stop driving the vehicle when you notice a lack of power. Driving the vehicle when the battery is discharged can cause the receiver to power off. You may lose control of the vehicle.
- Do not apply the throttle in forward or reverse if the vehicle is stuck. Applying throttle in this instance can damage the motor or ESC.
- After driving the vehicle, allow the electronics to cool to ambient temperature before using the next battery pack.

## RUN TIME

The largest factor in run time is the capacity of the battery pack. A larger mAh rating increases the amount of run time.

The condition of a battery pack is also an important factor in both run time and speed. The battery connectors may become hot during driving. Batteries will lose performance and capacity over time.

Driving the vehicle from a stop to full speed repeatedly will damage the batteries and electronics over time. Sudden acceleration will also lead to shorter run times.

## TO IMPROVE RUN TIMES

- Keep your vehicle clean and well maintained.
- Allow more airflow to the ESC and motor.
- Change the gearing to a lower ratio. A lower ratio lowers the operating temperature of the electronics. Use a smaller pinion gear or larger spur gear to lower the gear ratio.
- Use a battery pack with a higher mAh rating.

# SPEKTRUM™ FIRMA™ SMART 130A BRUSHLESS ESC (SPMXSE2130S)

## SPECIFICATIONS

Type	Sensorless, SMART Throttle Compatible
Output	130A/760A
Function	Forward/Brake—Forward/Brake Reverse
Input Voltage	2- 4S LiPo / 6 - 12S NiMH
BEC Output	6V-7.4V
Dimensions (LxWxH)	57mm x 37mm (56mm at tabs) x 38mm
Weight	150 g

## ESC LED STATUS

- No ESC LEDs will glow when there is no throttle input from the transmitter.
- The red ESC LED glows when there is any throttle input from the transmitter.

## AUDIBLE WARNING TONES

- 1. Input Voltage:** The ESC checks the input voltage when it is powered ON. If a voltage problem is detected, the ESC continuously sounds 2 beeps with a 1 second pause (xx-xx-xx). Power OFF the ESC and ensure the connections are secure and that the battery power is not too low for safe operation.
- 2. Radio Connection:** The ESC checks radio signal input when it is powered ON. If a problem is detected, the ESC continuously sounds 1 beep with a 2 second pause (x--x--x). Power OFF the ESC and ensure the radio system is operating correctly.

**NOTICE:** Always disconnect the battery from the ESC after operating your vehicle. The ESC's switch only controls power to the receiver and servos. The ESC will continue to draw current when connected to the battery, resulting in possible damage to the battery through over discharge.

## BODY PAINTING PROCEDURE

The included body will come with secondary parts of the body screened with color. Choose a color to paint as the main color of the body. Ensure to use polycarbonate paint.

- 1.** Clean the inside of the body shell using a small amount of water and dish soap. Thoroughly rinse and dry the body shell with a cloth towel.  
**Tip:** Do not use paper towels.
- 2.** Paint the inside of the body shell.
- 3.** Once the paint is completely dry, remove the over-spray film from the outside of the body.
- 4.** Apply additional stickers to customize the body.

## ESC CALIBRATION PROCEDURE

Complete the transmitter/receiver binding procedure prior to calibrating the ESC.

- 1.** Set the transmitter throttle channel to 100% travel and center the throttle trim.
- 2.** Connect a battery to the ESC battery lead.
- 3.** Power on the transmitter.
- 4.** Press and hold the SET button while turning on the ESC. Release the SET button when the **red** LED begins to flash, indicating the ESC is in calibration mode. The ESC will enter programming mode if the button is held for more than three seconds.

**TIP:** The red LED should be flashing when the ESC enters calibration mode. If the green LED is flashing the ESC has entered programming mode. Power off the ESC and repeat step 4, releasing the SET button when the red LED begins to flash.

- 5.** With the transmitter throttle trigger at the neutral position, press and release the ESC SET button. The red LED will stop flashing, the green LED will flash one time and the motor will make a tone to indicate the neutral position has been accepted.
- 6.** While holding the throttle trigger at the full throttle position, press and release the ESC SET button. The green LED will flash twice and the motor will make two tones to indicate the full throttle position has been accepted.
- 7.** While holding the throttle trigger at the full brake position, press and release the SET button. The green LED will flash three times and the motor will make three tones to indicate the full brake position has been accepted.

The motor will operate normally after calibration is completed.

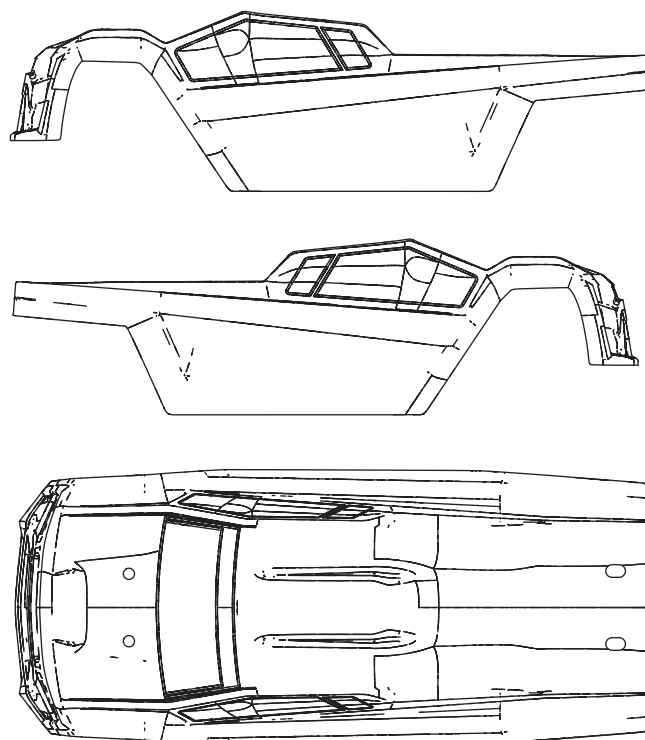

## ESC FUNCTIONS AND MODES

The ESC includes programming options so you can adjust the way your vehicle performs. Refer to the included programming table to adjust the ESC for your driving conditions.

■ Default Settings

### PROGRAMMING TABLE

PROGRAMMING ITEMS	PROGRAMMING VALUE								
	1	2	3	4	5	6	7	8	9
1. Running Mode	Forward w/ brake	Forward/Reverse w/ Brake	Forward/Reverse						
2. Max Reverse Force	25%	50%	75%	100%					
3. Li-Po Cells	Auto Calculate	2S	3S	4S					
4. Cutoff Voltage	2.8V/Cell	3.1V/Cell	3.2V/Cell	3.3V/Cell	3.4V/Cell	3.5V/Cell	3.6V/Cell		
5. BEC Voltage	6.0V	7.4V							
6. Motor Rotation	Counterclockwise	Clockwise							
7. Punch (level)	1	2	2	4	5	6	7	8	9
8. Initial Throttle Force	0.5%	1%	2%	3%	4%	6%	+	7%	8%
9. PWM Drive Frequency (K)	2K	3K	4K	8K	12K	16K	24K	32K	
10. Drag Brake Force	0%	5%	10%	20%	40%	60%	80%	100%	
11. Max Brake Force	12.5%	25%	37.5%	50%	62.5%	75%	87.5%	100%	Disable
12. Brake Frequency (K)	0.5K	1K	2K	4K	8K	16K			
13. Turbo Timing	0°	4°	8°	12°	16°	20°	24°	28°	32°
14. Turbo Delay	Instant	0.05s	0.1s	0.15s	0.2s	0.3s	0.5s	0.7s	1.0s

### ESC PROGRAMMING PROCEDURE

Programming is accomplished using the SET button on the ON/OFF switch\*.

1. Connect a fully charged battery to the ESC.
2. Power on the transmitter.
3. Power on the ESC.
4. Hold the SET button until the green LED flashes. Release the set button to enter programming mode.

**TIP:** To reset all programming items to the default values, press and hold the set button for five seconds

5. Press and release the set button as needed to cycle through the programming

\* Other programming options include the Spektrum SMART Firma ESC Programming Box (SPMXCA200) and the SmartLink USB updating and programmer application. See SpektrumRC.com for more details about Spektrum SMART Firma ESCs.

items. The number of times the green LED flashes equals the programming item number given in the programming table.

6. When at the desired programming item, press and hold the set button until the red LED flashes to select the item.
7. Press and release the SET button to cycle through the values available for the programming item based on the number of times the LED flashes. Refer to the programming table.
8. Save the setting by pressing and holding the SET button for 3 seconds.
9. Power off the ESC to exit programming mode or to change other programming items.

### DESCRIPTIONS

#### 1. Running Mode

- *Forward Only with Brake*

Intended for competition use, this mode allows only forward and brake controls.

- *Forward/Reverse with Brake*

This mode is the basic all-around mode, allowing forward, reverse and brake controls. To engage reverse while moving forward, apply the brake until the vehicle has come to a complete stop, release brake, then apply the brake again. While braking or in reverse, engaging the throttle will result in the vehicle immediately accelerating forward.

#### 2. Max Reverse Force

This parameter adjusts the maximum power when travelling in reverse.

#### 3. Li-Po Cells

Allows the ESC to automatically detect or manually set the number of cells in your Li-Po battery pack.

#### 4. Cutoff Voltage

This function helps to prevent battery over-discharge. The ESC continuously monitors the battery's voltage. If the voltage falls below the voltage threshold for 2 seconds, the output power shuts off and the red LED flashes twice repeatedly.

The cutoff threshold calculation is based on individual Li-Po cell voltage. For Ni-MH batteries, if the voltage battery pack is higher than 9.0V, it will be treated as a 3-cell Li-Po battery pack; if it is lower than 9.0V, it will be treated as a 2-cell Li-Po battery pack. Example: for a 8.0V Ni-MH battery pack used with a 2.6V/cell threshold, it will be treated as a 2-cell Li-Po battery pack and the low-voltage cut-off threshold will be 5.2V (2.6x2=5.2).

#### 5. BEC Voltage

It supports 6.0V/7.4V adjustable. 6.0V is applicable to common servo. If use high-voltage servo, set to higher voltage according to voltage marking of servo.

**Note:** 1. Do not set the BEC voltage above the maximum operating voltage of the servo, as this may damage the servo or even the ESC.

2. Due to the characteristics of the BEC circuit, there is a voltage difference between the BEC output voltage and the input voltage, when the BEC voltage is set to 7.4V and 2S Lipo is used, the BEC cannot stably output 7.4V (will decrease as the battery voltage decreases). Therefore, it is recommended to use 7.4V BEC when matching with 3S Lipo and above.

#### 6. Motor Rotation

Allows you to make this change in the ESC so no wires need to be changed between the ESC and the motor.

#### 7. Punch

Sets the initial throttle punch when the car accelerates. Level 1 gives a very soft initial acceleration and level 4 gives a stronger initial acceleration.

#### 8. Initial Throttle Force

It also called as minimum throttle force. You can set it according to wheel tire and traction. If the ground is slippery, please set a small throttle force.

#### 9. PWM Drive Frequency

The acceleration will be more aggressive at the initial stage when the drive frequency is low; a higher drive frequency is smoother but this will create more heat to the ESC. If set this item to "Customized", then the PWM frequency can be adjusted to a variable value (which ranges from 2K to 32K) at any 0-100% throttle input. Please choose the frequencies as per the actual test results of your vehicles.

#### 10. Drag Brake Force

Adjusts the amount of brake automatically applied when the throttle is returned to the neutral position. This simulates the engine braking effect of a full-scale vehicle, allowing improved turn-in and your vehicle's general response to controls.

#### 11. Max Brake Force

Adjusts the maximum braking force. A higher value provides stronger braking, but can also cause the wheels to lock, resulting in loss of control of the car.

#### 12. Brake Frequency

The brake force will be larger if the frequency is low; you will get a smoother brake force when the value is higher, please choose the frequencies as per the actual test results of your vehicles.

#### 13. Turbo Timing

This item is adjustable from 0 degree to 48 degrees, the corresponding turbo timing (you set) will initiate at full throttle. It's usually activated on long straightaway and makes the motor unleash its maximum potential.

#### 14. Turbo Delay

When "TURBO DELAY" is set to "INSTANT", the Turbo Timing will be activated right after the throttle trigger is moved to the full throttle position. When other value(s) is applied, you will need to hold the throttle trigger at the full throttle position (as you set) till the Turbo Timing initiates.

**NOTICE:** Always ensure the motor timing is set correctly. Failure to set the motor timing correctly can result in damage to the motor and ESC. Refer to the manufacturer instructions for recommended timing settings.

# SPEKTRUM™ FIRMA™ 2250KV 4-POLE BRUSHLESS MOTOR

## PRECAUTIONS

- Never touch moving parts.
- Never disassemble while the batteries are installed.
- Always let parts cool before touching.
- Rated for up to 4S batteries.

## GEARING

Installing a pinion gear with fewer teeth will provide greater torque but will reduce top speed. Likewise, a pinion gear with more teeth will reduce torque and increase top speed. Care should be taken when installing larger pinion gears as this can "overgear" the vehicle, resulting in overheating of the motor and ESC. When testing different gearing options, pay close attention to the temperature of the motor and speed control to ensure you are operating within the temperature range of the components. The motor or ESC should never be so hot that it cannot be touched. If temperatures are too hot, a different gearing combination with a lower pinion gear and/or higher spur gear is suggested.

## RUN TIME

The largest factor in run time is the capacity of the battery pack. A larger mAh rating increases the amount of run time experienced.

The condition of a battery pack is also an important factor in both run time and speed. The battery connectors may become hot during driving. Batteries will lose performance and capacity over time.

Driving the vehicle from a stop to full speed repeatedly will damage the batteries and electronics over time. Sudden acceleration will also lead to shorter run times.

## TO IMPROVE RUN TIMES

- Keep your vehicle clean and well maintained.
- Allow more airflow to the ESC and motor.
- Change the gearing to a lower ratio. A lower ratio decreases the operating temperature of the electronics. Use a smaller pinion gear or larger spur gear to lower the gear ratio.
- Use a battery pack with a higher mAh rating.
- Use the optimum charger to charge battery packs (Visit your local hobby dealer for more information).

LIST OF FLUIDS	
Diff Fluids	
Front and Rear	10k / 6k
Center	12k
Shock Oil	
Front and Rear	45wt (TLR74026)

REQUIRED TOOLS
1.5mm Hex Driver
2.0mm Hex Driver
2.5mm Hex Driver
5.5mm Nut Driver
17mm Wheel Wrench

## CHANGING THE PINION GEAR/GEAR RATIO

1. Loosen the two screws holding the motor in place, loosen the pinion gear set screw and remove the pinion gear.
2. Remove the motor mounting screws to remove the motor, or adjust the motor to the location for the corresponding pinion gear.
3. Install the new pinion gear on your motor. Place the pinion gear on the end of the motor shaft so that it lines up flush with the spur gear and the set screw is located over the flat on the shaft.
4. Tighten the pinion gear on the motor shaft and tighten motor mounting screws after ensuring proper gear mesh.

STOCK PINION
15T MOD1, 5mm shaft



## VEHICLE MAINTENANCE

The following items require semi-frequent maintenance. Always clean screw threads and apply removeable thread locking compound when threading machine screws into metal parts.

## SHOCK DISASSEMBLY/CLEANING

Remove the shocks and service as needed. Replace worn parts.

1. Remove shock cup screw. Pull the spring up and away from the lower cup. Slide the lower spring cup up and off of the shaft. Clean with a soft brush.
2. Use the shock tools to hold the shock body and remove the top cap. Empty the fluid from out of the shock.
3. Hold the shaft with a multi-wrench and remove the shock end. Push the shaft into the shock body and remove through the top. Remove the lower shock cap, dust cover, O-rings and spacer. Clean the shock body. Install new O-rings, re-install the spacer, replace the O-ring and install the lower shock cap. DO NOT TIGHTEN. Install the shock shaft through the shock bottom and tighten the bottom cap. Re-install the boot and shock end on the shaft.

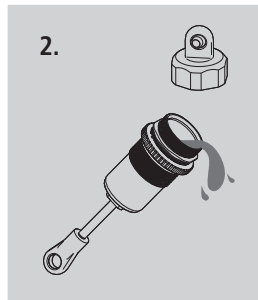
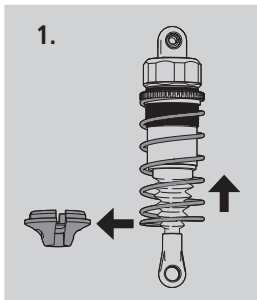

## REFILLING/BLEEDING SHOCKS

1. Fill the shock body 5mm (0.2 in) from the top with (45wt front shock TLR74026 4oz) (45wt rear shock TLR74026 4oz) silicone shock oil.
2. Slowly move the piston up and down 5 times, allowing air to rise to the top. Let the shock sit for 5 minutes.
3. With the piston all the way down, fill the shock body 1mm (0.04 in) from the top. Move piston to level with oil. Replace the shock cap, spring and spring cup.

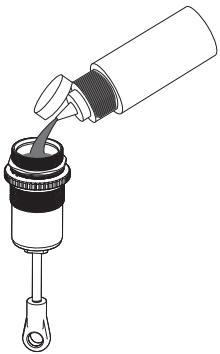

Stock Shock oil:  
Front: 45wt  
Rear: 45wt  
Piston F/R: 5x1.5mm

### FRONT SHOCK

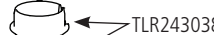
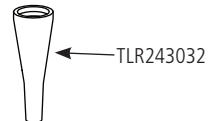
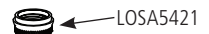
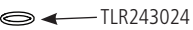
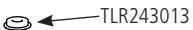
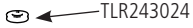
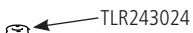
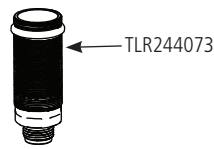
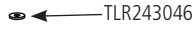
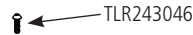

### REAR SHOCK

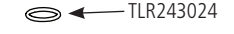
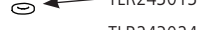
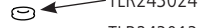
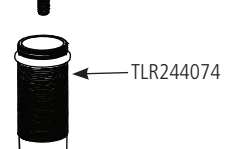
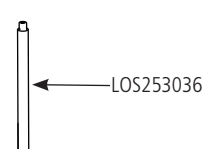
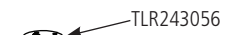
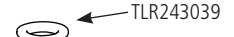

## TUNING, ADJUSTING & MAINTAINING YOUR VEHICLE

- Examine your vehicle on a regular basis.
- Use a brush to remove dirt and dust.
- Look for damage to the suspension arms and other molded parts.
- Re-glue the tires to the wheels, if necessary.
- Use suitable tools to tighten fasteners.
- Make sure the camber and steering linkages are not bent. Replace any bent linkages.
- Remove the shocks and inspect them for damage. Rebuild the shocks if oil is leaking.
- Inspect electronics and batteries for exposed wires. Repair exposed wires with shrink-wrap or replace the wire.
- Make sure the ESC and receiver are secure on the chassis. Replace the double-sided tape, if necessary.
- Power on the transmitter. If the green LED is dim or off, replace the AA batteries in your transmitter.
- Check the spur gear for wear.

## CHANGING THE TRAVEL ADJUST SETTINGS



**WARNING:** Unplug 2 of the 3 motor wires to prevent the car from running away when setting the EPA (travel).

1. Hold the trigger in the full brake position and the steering wheel full right while powering on the transmitter. The LED flashes rapidly, indicating the programming mode is active.

2. **Throttle End Point:** Hold the throttle trigger to full throttle while turning the TH TRIM knob clockwise until it stops. Turn the TH TRIM knob to adjust the full throttle end point.
3. **Brake End Point:** Hold the trigger in the full brake position. Turn the TH TRIM knob clockwise until it stops. Return the trigger to the center position.
4. **Left Steering End Point:** Hold the steering wheel in the full left position. Turn the ST TRIM knob to adjust the left end point.
5. **Right Steering End Point:** Hold the steering wheel in the full right position. Turn the ST TRIM knob to adjust the right end point. Return the steering wheel to the center position.
6. Power off the transmitter to save the travel adjust settings.

The minimum Travel is 75%, and the Maximum travel is 150%.

## SERVICE/REPAIR

### RADIO/SPEED CONTROL & MOTOR

If any problems other than those covered in the troubleshooting section arise, please call the appropriate electronics service department. They will be able to give the problem additional specific attention and provide instructions for the solution.

### MAINTENANCE

If any questions other than those covered in the troubleshooting or maintenance sections arise, please call the appropriate Horizon product support department.

### CLEANING

Performance can be hindered if dirt gets in any of the moving suspension parts. Use compressed air, a soft paintbrush, or a toothbrush to remove dust or dirt. Avoid using solvents or chemicals as they can actually wash dirt into the bearings or moving parts, as well as cause damage to the electronics.

## TROUBLESHOOTING GUIDE

PROBLEM	POSSIBLE CAUSE	SOLUTION
Vehicle does not operate	Battery not charged or plugged in	Charge battery/plug in
	ESC switch not "On"	Turn on ESC switch
	Transmitter not "On" or low battery	Turn on/replace batteries
Motor runs but wheels do not rotate	Pinion not meshing with spur gear	Adjust pinion/spur mesh
	Pinion spinning on motor shaft	Tighten pinion gear setscrew on motor shaft flat spot
	Transmission gears stripped	Replace transmission gears
	Drive pin broken	Check and replace drive pin
Steering does not work	Servo plug not in receiver properly	Make sure the steering servo plug is connected to the receiver steering channel, noting proper polarity
	Servo gears or motor damaged	Replace or repair servo
Will not turn one direction	Servo gears damaged	Replace or repair servo
Motor does not run	Motor wire solder joint is damaged	Resolder the motor wire with the proper equipment
	Motor wire broken	Repair or replace as needed
	ESC damaged	Contact Horizon Hobby Product Support
ESC gets hot	Motor over-gearred	Use smaller pinion or larger spur gear
	Driveline bound up	Check wheels and transmission for binding
Poor run time and/or sluggish acceleration	Battery pack not fully charged	Recharge battery
	Charger not allowing full charge	Try another charger
	Driveline bound up	Check wheels, transmission for binding
Poor range and/or glitching	Transmitter batteries low	Check and replace
	Vehicle battery low	Recharge battery
	Loose plugs or wires	Check all wire connections and plugs

## LIMITED WARRANTY

### What this Warranty Covers

Horizon Hobby, LLC, (Horizon) warrants to the original purchaser that the product purchased (the "Product") will be free from defects in materials and workmanship for a period of 2 years from the date of purchase.

### What is Not Covered

This warranty is not transferable and does not cover (i) cosmetic damage, (ii) damage due to acts of God, accident, misuse, abuse, negligence, commercial use, or due to improper use, installation, operation or maintenance, (iii) modification of or to any part of the Product, (iv) attempted service by anyone other than a Horizon Hobby authorized service center, (v) Product not purchased from an authorized Horizon dealer, or (vi) Product not compliant with applicable technical regulations or (vii) use that violates any applicable laws, rules, or regulations. OTHER THAN THE EXPRESS WARRANTY ABOVE, HORIZON MAKES NO OTHER WARRANTY OR REPRESENTATION, AND HEREBY DISCLAIMS ANY AND ALL IMPLIED WARRANTIES, INCLUDING, WITHOUT LIMITATION, THE IMPLIED WARRANTIES OF NON-INFRINGEMENT, MERCHANTABILITY AND FITNESS FOR A PARTICULAR PURPOSE. THE PURCHASER ACKNOWLEDGES THAT THEY ALONE HAVE DETERMINED THAT THE PRODUCT WILL SUITABLY MEET THE REQUIREMENTS OF THE PURCHASER'S INTENDED USE.

### Purchaser's Remedy

Horizon's sole obligation and purchaser's sole and exclusive remedy shall be that Horizon will, at its option, either (i) service, or (ii) replace, any Product determined by Horizon to be defective. Horizon reserves the right to inspect any and all Product(s) involved in a warranty claim. Service or replacement decisions are at the sole discretion of Horizon. Proof of purchase is required for all warranty claims. SERVICE OR REPLACEMENT AS PROVIDED UNDER THIS WARRANTY IS THE PURCHASER'S SOLE AND EXCLUSIVE REMEDY.

### Limitation of Liability

HORIZON SHALL NOT BE LIABLE FOR SPECIAL, INDIRECT, INCIDENTAL OR CONSEQUENTIAL DAMAGES, LOSS OF PROFITS OR PRODUCTION OR COMMERCIAL LOSS IN ANY WAY, REGARDLESS OF WHETHER SUCH CLAIM IS BASED IN CONTRACT, WARRANTY, TORT, NEGLIGENCE, STRICT LIABILITY OR ANY OTHER THEORY OF LIABILITY, EVEN IF HORIZON HAS BEEN ADVISED OF THE POSSIBILITY OF SUCH DAMAGES. Further, in no event shall the liability of Horizon exceed the individual price of the Product on which liability is asserted. As Horizon has no control over use, setup, final assembly, modification or misuse, no liability shall be assumed nor accepted for any resulting damage or injury. By the act of use, setup or assembly, the user accepts all resulting liability. If you as the purchaser or user are not prepared to accept the liability associated with the use of the Product, purchaser is advised to return the Product immediately in new and unused condition to the place of purchase.

### Law

These terms are governed by Illinois law (without regard to conflict of law principals). This warranty gives you specific legal rights, and you may also have other rights which vary from state to state. Horizon reserves the right to change or modify this warranty at any time without notice.

## WARRANTY SERVICES

### Questions, Assistance, and Services

Your local hobby store and/or place of purchase cannot provide warranty support or service. Once assembly, setup or use of the Product has been started, you must contact your local distributor or Horizon directly. This will enable Horizon to better answer your questions and service you in the event that you may need any assistance. For questions or assistance, please visit our website at [www.horizonhobby.com](http://www.horizonhobby.com).

submit a Product Support Inquiry, or call the toll free telephone number referenced in the Warranty and Service Contact Information section to speak with a Product Support representative.

### Inspection or Services

If this Product needs to be inspected or serviced and is compliant in the country you live and use the Product in, please use the Horizon Online Service Request submission process found on our website or call Horizon to obtain a Return Merchandise Authorization (RMA) number. Pack the Product securely using a shipping carton. Please note that original boxes may be included, but are not designed to withstand the rigors of shipping without additional protection. Ship via a carrier that provides tracking and insurance for lost or damaged parcels, as Horizon is not responsible for merchandise until it arrives and is accepted at our facility. An Online Service Request is available at [http://www.horizonhobby.com/content/service-center\\_render-service-center](http://www.horizonhobby.com/content/service-center_render-service-center). If you do not have internet access, please contact Horizon Product Support to obtain a RMA number along with instructions for submitting your product for service. When calling Horizon, you will be asked to provide your complete name, street address, email address and phone number where you can be reached during business hours. When sending product into Horizon, please include your RMA number, a list of the included items, and a brief summary of the problem. A copy of your original sales receipt must be included for warranty consideration. Be sure your name, address, and RMA number are clearly written on the outside of the shipping carton.

**NOTICE: Do not ship Li-Po batteries to Horizon. If you have any issue with a Li-Po battery, please contact the appropriate Horizon Product Support office.**

### Warranty Requirements

**For Warranty consideration, you must include your original sales receipt verifying the proof-of-purchase date.** Provided warranty conditions have been met, your Product will be serviced or replaced free of charge. Service or replacement decisions are at the sole discretion of Horizon.

### Non-Warranty Service

**Should your service not be covered by warranty, service will be completed and payment will be required without notification or estimate of the expense unless the expense exceeds 50% of the retail purchase cost.** By submitting the item for service you are agreeing to payment of the service without notification. Service estimates are available upon request. You must include this request with your item submitted for service. Non-warranty service estimates will be billed a minimum of ½ hour of labor. In addition you will be billed for return freight. Horizon accepts money orders and cashier's checks, as well as Visa, MasterCard, American Express, and Discover cards. By submitting any item to Horizon for service, you are agreeing to Horizon's Terms and Conditions found on our website [http://www.horizonhobby.com/content/service-center\\_render-service-center](http://www.horizonhobby.com/content/service-center_render-service-center).

**ATTENTION:** Horizon service is limited to Product compliant in the country of use and ownership. If received, a non-compliant Product will not be serviced. Further, the sender will be responsible for arranging return shipment of the un-serviced Product, through a carrier of the sender's choice and at the sender's expense. Horizon will hold non-compliant Product for a period of 60 days from notification, after which it will be discarded.

10/15

## WARRANTY AND SERVICE CONTACT INFORMATION

Country of Purchase	Horizon Hobby	Contact Information	Address
United States of America	Horizon Service Center (Repairs and Repair Requests)	servicecenter.horizonhobby.com/RequestForm/	2904 Research Rd. Champaign, Illinois, 61822 USA
	Horizon Product Support (Product Technical Assistance)	productsupport@horizonhobby.com 877-504-0233	
	Sales	websales@horizonhobby.com 800-338-4639	
European Union	Horizon Technischer Service	service@horizonhobby.de	Hanskampring 9 D 22885 Barsbüttel, Germany
	Sales: Horizon Hobby GmbH	+49 (0) 4121 2655 100	

## FCC INFORMATION

Contains FCC ID: BRWKATY1T

FCC ID: BRWSRIRVINGV1

### Supplier's Declaration of Conformity

LOS 8IGHT-XTE, RTR (LOS04018)

 This device complies with part 15 of the FCC Rules. Operation is subject to the following two conditions: (1) This device may not cause harmful interference, and (2) this device must accept any interference received, including interference that may cause undesired operation.

 **CAUTION:** Changes or modifications not expressly approved by the party responsible for compliance could void the user's authority to operate the equipment.

NOTE: This equipment has been tested and found to comply with the limits for a Class B digital device, pursuant to part 15 of the FCC Rules. These limits are designed to provide reasonable protection against harmful interference in a residential installation. This equipment generates, uses and can radiate radio frequency energy and, if not installed and used in accordance with the instructions, may cause harmful interference to radio communications. However, there is no guarantee that interference will not occur in a particular installation.

If this equipment does cause harmful interference to radio or television reception, which can be determined by turning the equipment off and on, the user is encouraged to try to correct the interference by one or more of the following measures:

- Reorient or relocate the receiving antenna.
- Increase the separation between the equipment and receiver.
- Connect the equipment into an outlet on a circuit different from that to which the receiver is connected.
- Consult the dealer or an experienced radio/TV technician for help.

Horizon Hobby, LLC  
2904 Research Rd.,  
Champaign, IL 61822  
Email: [compliance@horizonhobby.com](mailto:compliance@horizonhobby.com)  
Web: [HorizonHobby.com](http://HorizonHobby.com)

## IC INFORMATION

CAN ICES-3 (B)/NMB-3(B)

Contains IC: 6157A-KATY1T

IC: 6157A-SRIRVINGV1

This device contains license-exempt transmitter(s)/receivers(s) that comply with Innovation, Science, and Economic Development Canada's license-exempt RSS(s). Operation is subject to the following 2 conditions:

1. This device may not cause interference.
2. This device must accept any interference, including interference that may cause undesired operation of the device.

## COMPLIANCE INFORMATION FOR THE EUROPEAN UNION

 **EU Compliance Statement:**  
Losi 8IGHT-XTE, RTR (LOS04020)

Hereby, Horizon Hobby, LLC declares that the device is in compliance with the following: EU Radio Equipment Directive (RED) 2014/53/EU; RoHS 2 Directive 2011/65/EU; RoHS 3 Directive - Amending 2011/65/EU Annex II 2015/863.

The full text of the EU declaration of conformity is available at the following internet address: <https://www.horizonhobby.com/content/support-render-compliance>.

**NOTE:** This product contains batteries that are covered under the 2006/66/EC European Directive, which cannot be disposed of with normal household waste. Please follow local regulations.

### Wireless Frequency Range and Wireless Output Power:

#### Transmitter:

2402–2478MHz

17.7 dBm

#### Receiver:

2404–2476MHz

-1.33dBm

### EU Manufacturer of Record:

Horizon Hobby, LLC  
2904 Research Road  
Champaign, IL 61822 USA

### EU Importer of Record:

Horizon Hobby, GmbH  
Hanskampring 9  
22885 Barsbüttel Germany

### WEEE NOTICE:



This appliance is labeled in accordance with European Directive 2012/19/EU concerning waste of electrical and electronic equipment (WEEE). This label indicates that this product should not be disposed of with household waste. It should be deposited at an appropriate facility to enable recovery and recycling.









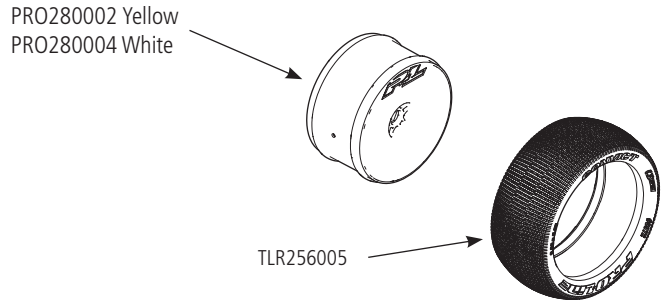
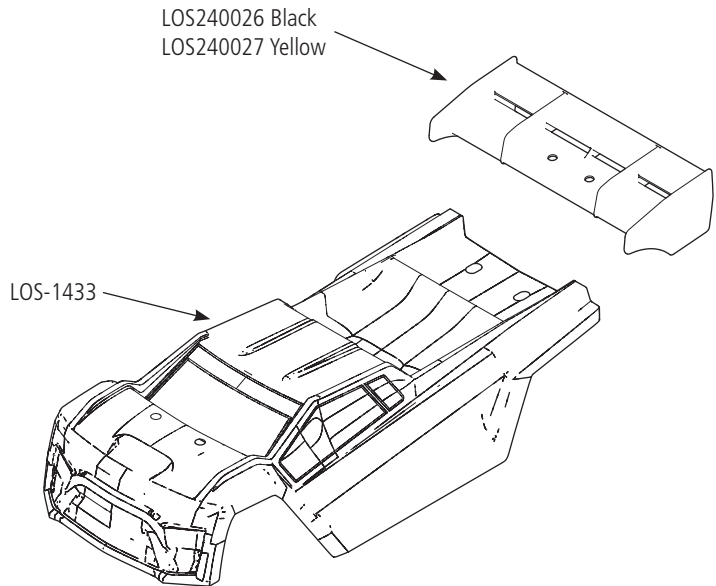

**CENTER DIFFERENTIAL**

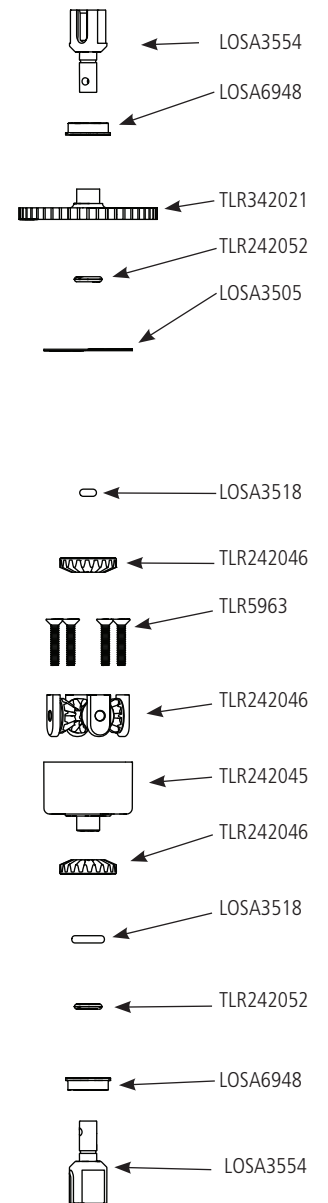



# REPLACEMENT PARTS // TEILELISTE // LISTE DES PIÈCES DE RECHANGE // ELENCO DEI RICAMBI

SKU	English	Deutsch	French	Italiano
PRO907202	1/8 Convict M3 F/R 4.0 Off-Road 1:8 Truck Trs (2)	1/8 Convict M3 F/R 4.0 Off-Road 1:8 Truck Reifen (2)	Camion Convict M3 F/R 4.0 Trs tout-terrain 1:8 (2)	1/8 Convict M3 F/R 4.0 Off-Road 1:8 Truck Trs (2)
LOSA6955	5x13x4mm HD Clutch Bearings (2):8B/8T	5 x 13 x 4 mm HD Kupplungslager (2): 8B/8T	Roulements à embrayage ultra-résistants 5 x 13 x 4 mm (2) : 8B/8T	Cuscinetti frizione HD 5x13x4 mm (2):8B/8T
LOS240026	Wing, Black: 8X, 8XE, 8XT	Heckflügel, schwarz: 8X, 8XE, 8XT	Aile, noire : 8X, 8XE, 8XT	Alettone, nero: 8X, 8XE, 8XT
LOS240027	Wing, Yellow: 8X, 8XE, 8XT	Heckflügel, gelb: 8X, 8XE, 8XT	Aile, Jaune : 8X, 8XE, 8XT	Alettone, Giallo: 8X, 8XE, 8XT
LOS235024	Button Head Screws M3x25mm (10)	Rundkopfschrauben, M3 x 25 mm (10)	Vis à tête bombée M3x25 mm (10)	Viti testa tonda, M3x25 mm (10)
LOS236001	3.2mm x 7mm x .5mm Washer (10)	3,2 mm x 7mm x 0,5 mm Unterlegscheibe (10)	Rondelle, 3,2 mm x 7 mm x 0,5 mm (10)	Rondelle 3,2x7x0,5 mm (10)
LOS235011	Set Screws, M3 x 3mm Cup Point(10)	Stellschrauben, M3 x 3 mm Ringschneide (10)	Vis de pression M3 x 3 mm à bout cuvette (10)	Kit viti, M3x3 mm, senza testa (10)
LOS235012	Set Screw, M4 x 4mm Cup Point(10)	Stellschraube M4 x 4 mm Ringschneide (10)	Vis de pression M4 x 4 mm à bout cuvette (10)	Kit viti, M4x4 mm, senza testa (10)
LOS240028	Wing, White: 8X, 8XE, 8XT	Heckflügel, weiß: 8X, 8XE, 8XT	Aile, blanche : 8X, 8XE, 8XT	Alettone, Bianco: 8X, 8XE, 8XT
LOS235025	Button Head Screws M3x30mm (10)	Rundkopfschrauben, M3 x 30 mm (10)	Vis à tête bombée M3 x 30 mm (10)	Viti testa tonda, M3x30 mm (10)
LOS235018	Set Screw, M3 X 3mm (10)	Stellschraube, M3 x 3 mm (10)	Vis de fixation, M3x3 mm (10)	Viti di fermo, M3x3 mm (10)
LOSA6350	#4 and 1/8 Hardened Washers	#4 und 1/8 gehärtete Unterlegscheiben	Rondelles renforcées #4 et 1/8	Rondelle indurite #4 e 1/8
LOSA6356	Shim Set, Metric 5mm/6mm	Dichtscheiben-Satz, metrisch 5 mm/6 mm	Jeu de cales, métrique 5 mm/6 mm	Set spessori, metrico 5 mm/6 mm
LOSA3554	Center HD Lightened Differential Outdrives (2)	Heavy Duty Antriebsklauen für Mitteldifferential, Leichtbau (2)	Entraînements extérieurs différentiels allégés ultra-résistants centraux (2)	Outdrive diff. leggeri HD centrali (2)
LOSA6946	6x10x3 Rubber Sealed Ball Bearing (4)	6 x 10 x 3 Kugellager m. Gummidichtung (4)	Roulement à billes hermétiques en caoutchouc 6 x 10 x 3 (4)	Cuscinetti a sfera sigillati in gomma 6x10x3 (4)
LOSA6947	5x11x4 Rubber Sealed Ball Bearing (4)	5 x 11 x 4 Kugellager m. Gummidichtung (4)	Roulement à billes hermétiques en caoutchouc 5 x 11 x 4 (4)	Cuscinetti a sfera sigillati in gomma 5x11x4 (4)
LOSA5421	15mm Shock Caps Bottom (2): 8B 8T	15 mm Stoßdämpferkappen unten (2): 8B 8T	Capuchons d'amortisseurs bas 15 mm (2) : 8B 8T	Tappi amm. inferiori 15 mm (2): 8B 8T
LOSA6948	8x14x4 Flanged Rubber Seal Ball Bearing (4)	8 x 14 x 4 Kugellager m. Flanschgummidichtung (4)	Roulement à billes hermétique en caoutchouc à collet 8 x 14 x 4 (4)	Cuscinetti a sfera sigillati in gomma flangiati 8x14x4 mm (4)
LOSA3501	Differential Shims, 6x11x.2mm: 8B 2.0 (12)	Differential-Ausgleichsscheiben, 6x11x.2mm: 8B 2.0 (12)	Cales de différentiel, 6 x 11 x 0,2 mm : 8B 2.0 (12)	Spessori differenziale, 6x11x0,2 mm: 8B 2.0 (12)
LOSA6942	8x16x5mm Sealed Ball Bearing (4)	8 x 16 x 5 mm abgedichtetes Kugellager (4)	Roulement à billes hermétique 8 x 16 x 5 mm (4)	Cuscinetti a sfera sigillato 8x16x5 mm (4)
LOSA3575	1.0 Module Pitch Pinion, 15T: 8E,SCTE	1.0 Modul Getrieberad, 15T: 8E, SCTE	Pignon de pas module 1.0, 15 dents : 8E,SCTE	Pignone passo modulo 1.0, 15T: 8E,SCTE
LOSA3518	Drive Pin Set: 8B/8T	Mitnehmerbolzen-Satz: 8B/8T	Ensemble de broche d'entraînement : 8B/8T	Set perni trasmissione: 8B/8T
SPMSR315	SR315 DSMR 3 CH Receiver	SR315 DSMR 3-Kanal-Empfänger	Récepteur SR315 DSMR 3 canaux	Ricevitore SR315 DSMR 3 CH
PRO280002	1/8 Truck Velocity VTR 4 Zero Offset Wheel YEL(4)	1/8 Truck Velocity VTR 4 Zero Offset Rad GELB(4)	Camion Velocity VTR 4, roues à décalage zéro, jaune 1/8 (4)	Ruote 1/8 Truck Velocity VTR 4 Zero GIALLE (4)
PRO280004	1/8 Truck Velocity VTR 4 Zero Offset Wheel WHT(4)	1/8 Truck Velocity VTR 4 Zero Offset Rad WEISS(4)	Camion Velocity VTR 4, roues à décalage zéro, blanc 1/8 (4)	Ruote 1/8 Truck Velocity VTR 4 Zero BIANCHE (4)
LOS255017	Flat Head Screws, Stl, BO, M4 x 16mm (10)	Flachkopfschrauben, Stl, BO, M4 x 16 mm (10)	Vis à tête plate, Inoxydable, BO, M4 x 16 mm (10)	Viti testa piana, Stl, BO, M4x16 mm (10)
SPM2340	DX3 SMART DSMR 3CH TX w/SR315	DX3 SMART DSMR TX mit 3 Kanälen mit SR315	Émetteur DX3 SMART DSMR 3 canaux avec SR315	TX DX3 SMART DSMR 3CH con SR315
TLR342021	Center Diff 46T Spur Gear, Lightweight: 8X	Mitteldifferential Stirnrad 46T, Leichtbau: 8X	Engrenage cylindrique 46T différentiel central, léger : 8X	Ingr. cilindrico, diff. centrale, 46T, leggero: 8X
TLR341009	Aluminum Servo Horn, 25T: 8X	Aluminium-Servohorn, 25T: 8X	Renvoi de commande du servo en aluminium, 25T : 8X	Squadretta servo alluminio, 25T: 8X
TLR3538	Covered 17mm Wheel Nuts, Alum: 8B/8T 2.0	Radmuttern geschlossen 17 mm, Alu: 8B/8T 2.0	Écrous de roue couverts 17 mm, aluminium : 8B/8T 2.0	Dadi ruota coperti 17 mm, Alu: 8B/8T 2.0
TLR336007	M3 x 6.5mm Aluminum Washer Set, Black (4ea)	M3 x 6,5 mm Unterlegscheiben-Satz, Alu, schwarz (je 4)	Ensemble de rondelles en aluminium M3 x 6,5 mm, noir (4 ea)	Rondelle alu M3x6,5 mm, nero (4ea)
TLR241079	Drag Link: 8X, 8XE 2.0	Lenkzwischenstange: 8X, 8XE 2.0	Barre d'accouplement : 8X, 8XE 2.0	Leva a squadra: 8X, 8XE 2.0
TLR244051	Suspension Ball, 6.8mm, Flanged (4): 8X	Kugelpopf mit Flansch, 6,8 mm (4): 8X	Rotule de suspension, 6,8 mm, à collet (4) : 8X	Sfera sospensione, 6,8 mm, flangiata (4): 8X
TLR255007	Button Head Screws, M4x12mm (10)	Rundkopfschrauben, M4 x 12 mm (10)	Vis à tête bombée, M4x12 mm (10)	Viti testa tonda, M4x12 mm (10)
TLR244071	Shock Tower, Front: 8XT	Stoßdämpferbrücke, vorn: 8XT	Tour d'amortisseur, avant : 8XT	Torre ammortizzatore, Anteriore: 8XT
TLR243056	16mm Shock Piston Set, Taper 5x1.5 V2: 8	16 mm Stoßdämpfer-Kolbensatz, konisch, 5 x 1,5 V2: 8	Ensemble de piston d'amortisseur conique 16 mm 5 x 1,5 V2 : 8	Set piston per ammortizzatori 16 mm, conici 5x1,5 V2: 8

SKU	English	Deutsch	French	Italiano
TLR243046	Shock Washer, Screw (4): 8X	Unterlegscheibe Stoßdämpfer, Schraube (4): 8X	Rondelle d'amortisseur, vis (4) : 8X	Rondella amm., vite (4): 8X
TLR244064	Spring Set, Front: 8XT	Federnsatz, Vorn: 8XT	Ensemble ressort, avant : 8XT	Kit molle, Anteriore: 8XT
TLR255002	Button Head Screws, M2.5x10mm (10)	Rundkopfschrauben, M2,5 x 10 mm (10)	Vis à tête bombée, M2,5 x 10 mm (10)	Viti testa tonda, M2,5x10 mm (10)
TLR245016	M3 Flanged Lock Nuts (10)	M3 Sicherungsmuttern mit Flansch (10)	Contre-écrous à collet M3 (10)	Dadi flangiati M3 (10)
TLR242040	Universal Driveshaft (2): 8XT	Universal-Antriebswelle (2): 8XT	Arbre de transmission universelle (2) : 8XT	Albero trasmissione universale (2): 8XT
TLR242053	Front Lightened Outdrive Set, +1 (2): 8X, 8XE 2.0	Frontantriebssatz, Leichtbau, +1 (2): 8X, 8XE 2.0	Ensemble d'arbre extérieur allégé avant, +1 (2) : 8X, 8XE 2.0	Set outdrive leggeri ant, +1 (2): 8X, 8XE 2.0
TLR244077	Turnbuckle, Steering(2): 8XT	Spannschraube, Lenkung(2): 8XT	Ridoir, direction (2) : 8XT	Tenditore, Sterzo (2): 8XT
TLR256005	Nylock Nut, M4 (10)	Nylock-Mutter, M4 (10)	Écrou nyloc, M4 (10)	Dado Nylock, M4 (10)
TLR5909	Button Head Screws, M3 x 16mm (10)	Rundkopfschrauben, M3 x 16 mm (10)	Vis à tête bombée, M3 x 16 mm (10)	Viti testa tonda, M3x16mm (10)
TLR244075	Turnbuckle, Front(2): 8XT	Spannschraube, vorn(2): 8XT	Ridoir, avant (2) : 8XT	Tenditore, Anteriore (2): 8XT
TLR5962	Flathead Screws, M3 x 10mm (10)	Flachkopfschrauben, M3 x 10 mm (10)	Vis à tête plate, M3x10 mm (10)	Viti testa piana, M3x10 mm (10)
TLR242043	Rear Gear Box: 8XT	Hinteres Getriebegehäuse: 8XT	Boîte à engrenage arrière : 8XT	Scatola ingranaggi posteriore: 8XT
TLR244076	Turnbuckle, Rear(2): 8XT	Spannschraube, Heck(2): 8XT	Ridoir, arrière (2) : 8XT	Tenditore, Posteriore (2): 8XT
TLR244052	Suspension Ball, 6.8mm (4): 8X	Kugelkopf, 6,8 mm (4): 8X	Rotule de suspension, 6,8 mm (4) : 8X	Sfera sospensione, 6,8 mm (4): 8X
TLR244068	HD Rod End Set:8X	HD-Stangenkopfsatz: 8X	Ensemble embout de bielle ultrarésistant : 8X	Set teste a snodo HD: 8X
TLR245000	Droop Screw (4): 8B 3.0	Ausfederungsbegrenzer (4): 8B 3.0	Vis d'abaissement (4) : 8B 3.0	Viti abbassamento (4): 8B 3.0
TLR5932	Cap Head Screws, M3 x 10mm (10)	Inbusschrauben, M3 x 10 mm (10)	Vis d'assemblage creuses, M3x10 mm (10)	Viti testa cilindrica, M3x10 mm (10)
TLR241076	Side Guards: 8X, 8XE 2.0	Seitenschutz: 8X, 8XE 2.0	Protections latérales : 8X, 8XE 2.0	Protezioni laterali: 8X, 8XE 2.0
TLR242045	Heavy Duty Differential Case, V2: 8X	Robustes Differentialgehäuse, V2: 8X	Boîtier de différentiel hautement résistant, V2 : 8X	Scatola diff. heavy duty V2: 8X
TLR5904	Button Head Screws, M3 x 12mm (10)	Rundkopfschrauben, M3 x 12 mm (10)	Vis à tête bombée, M3 x 12 mm (10)	Viti testa tonda, M3x12 mm (10)
TLR243039	16mm Shock Seals, Emulsion (4): 8X	16 mm Stoßdämpfer-Dichtungen, Emulsion (4): 8X	Joints d'amortisseurs 16 mm, Émulsion (4) : 8X	Tenute amm. 16 mm, Emulsion (4): 8X
TLR243033	Shock Cap Bushing (4): 8IGHT & 8T 4.0	Stoßdämpferkappen (4): 8IGHT & 8T 4.0	Bague de capuchon d'amortisseur (4) : 8IGHT et 8T 4.0	Boccole tappi amm. (4): 8IGHT & 8T 4.0
TLR243013	Shock Guide & Bushing (8): 8IGHT Buggy 3.0	Stoßdämpferführung und Buchse (8): 8IGHT Buggy 3.0	Guide d'amortisseur et bague (8) : 8IGHT Buggy 3.0	Boccole e guide amm. (8): 8IGHT Buggy 3.0
TLR242046	Differential Gear & Shaft Set: 8X, 8XE 2.0	Differentialgetriebe und -wellensatz: 8X, 8XE 2.0	Ensemble d'arbre et d'engrenage différentiel : 8X, 8XE 2.0	Kit albero e ingr. diff.: 8X, 8XE 2.0
TLR244042	Spindle Carrier Set, 17.5deg: 8X	Spindelträgersatz, 17,5°: 8X	Ensemble de support d'axe, 17,5° : 8X	Set porta albero, 17,5deg: 8X
TLR5964	Flathead Screw, M3 x 16mm (10)	Flachkopfschraube, M3 x 16mm (10)	Vis à tête plate, M3x16 mm (10)	Viti testa piana, M3x16 mm (10)
TLR5911	Button Head Screws, M3 x 20mm (10)	Rundkopfschrauben, M3 x 20 mm (10)	Vis à tête bombée, M3 x 20 mm (10)	Viti testa tonda, M3x20 mm (10)
TLR241038	Bellcrank Set: 8X	Umlenkhebelsatz: 8X	Ensemble de levier coudé : 8X	Set leva a squadra: 8X
TLR245008	Cap Head Screws, M2x10mm (10)	Inbusschrauben, M2x10mm (10)	Vis d'assemblage creuses, M2x10 mm (10)	Viti testa cilindrica M2x10 mm (10)
TLR244065	Spring Set, Rear: 8XT	Federnsatz, Heck: 8XT	Ensemble ressort, arrière : 8XT	Kit molle, posteriori: 8XT
TLR243038	Shock Plastics: 8X	Stoßdämpfer Kunststoff: 8X	Plastiques de l'amortisseur : 8X	Plastiche ammortizzatori: 8X
TLR244090	Hinge Pins, 4 x 68mm, Elec Nickel (2): 8X, 8XE 2.0	Scharnierbolzen, 4 x 68 mm, Chemisch-Nickel (2): 8X, 8XE 2.0	Broches de charnière, 4 x 68 mm, Elec. Nickel (2) : 8X, 8XE 2.0	Perni articolazione 4x68 mm elettro nichel (2): 8X, 8XE 2.0
TLR244073	Shock Body, Front(2): 8XT	Stoßdämpfergehäuse, Front(2): 8XT	Carrosserie d'amortisseur, avant (2) : 8XT	Corpo amm., anteriore (2): 8XT
TLR5905	Button Head Screws, M3 x 18mm (10)	Rundkopfschrauben, M3 x 18 mm (10)	Vis à tête bombée, M3 x 18 mm (10)	Viti testa tonda, M3x18mm (10)
TLR6313	Locknut, M3 x .5 x 5.5mm (10)	Kontermutter, M3 x 0,5 x 5,5 mm (10)	Contre-écrou, M3x0,5x5,5 mm (10)	Controdadi M3x0,5x5,5 mm (10)
TLR5963	Flathead Screw, M3 x 12mm (10)	Flachkopfschraube, M3 x 12mm (10)	Vis à tête plate, M3x12 mm (10)	Viti testa piana, M3x12 mm (10)
TLR242051	HT F/R Lightened Outdrive Set (2): 8X	HT Front/Heck-Antriebssatz, Leichtbau (2): 8X	Ensemble arbre extérieur allégé avant/arrière HT (2) : 8X	Set outdrive leggeri Av/In HT (2): 8X
TLR242028	Center Drive Coupler: 8X	Zentrale Antriebskupplung: 8X	Coupleur d'entraînement central : 8X	Attacco albero trasmissione: 8X
TLR241071	Battery Tray, Center Diff & Servo Mount: 8XE 2.0	Batterieträger, Mitteldifferential- und Servo-Halterung: 8XE 2.0	Support de batterie, support différentiel central et servo : 8XE 2.0	Supporto batteria, supporto servo e differenziale centrale: 8XE 2.0
TLR255013	Flat Head Screws, M4x12mm (10)	Flachkopfschrauben, M4 x 12 mm (10)	Vis à tête plate, M4x12 mm (10)	Viti testa piana, M4x12 mm (10)

SKU	English	Deutsch	French	Italiano
TLR244072	Shock Tower, Rear: 8XT	Stoßdämpferbrücke, Heck: 8XT	Tour d'amortisseur, arrière : 8XT	Torre ammortizzatore, Posteriore: 8XT
TLR244044	Outer Hinge Pins, 3.5mm, Electro Nickel (2): 8X	Äußere Scharnierbolzen, 3,5 mm, Chemisch-Nickel (2): 8X	Broches de charnière externe, 3,5 mm, Électro Nickel (2) : 8X	Perni articolazione esterna, 3,5 mm, nichelatura elettrolitica (2): 8X
TLR5934	Cap Head Screws, M3 x 16mm (10)	Inbusschrauben, M3 x 16 mm (10)	Vis d'assemblage creuses, M3x16 mm (10)	Viti testa cilindrica, M3x16 mm (10)
TLR5906	Button Head Screws, M3 x 35mm (10)	Rundkopfschrauben, M3 x 35 mm (10)	Vis à tête bombée, M3 x 35 mm (10)	Viti testa tonda, M3x35mm (10)
TLR241077	Servo & Receiver Mounts: 8X 2.0	Servo- und Empfängerhalterungen: 8X 2.0	Supports pour servos et récepteurs : 8X 2.0	Supporti servo e ricevitore: 8X 2.0
TLR240016	Wing Mount: 8XT	Flügelhalterung: 8XT	Support d'aile : 8XT	Supporto alettone: 8XT
TLR243032	16mm Shock Boot Set (8): 8T 3.0	16 mm Stoßdämpfer-Manschettensatz (8): 8T 3.0	Ensemble de soufflet d'amortisseur 16 mm (8) : 8T 3.0	Set parapolvere amm. 16 mm (8): 8T 3.0
TLR244056	Shock Stand Off (4): 8X	Stoßdämpfer-Standoff (4): 8X	Dispositif d'espacement d'amortisseur (4) : 8X	Distanziatore amm. (4): 8X
TLR245006	Left Hand Button Head Screws, M3x20mm (4)	Rundkopfschrauben m. Linksgewinde, M3 x 20 mm (4)	Vis à tête bombée, côté gauche, M3 x 20 mm (4)	Viti testa tonda lato sinistro, M3x20 mm (4)
TLR255014	Flat Head Screws, M4x20mm (10)	Flachkopfschrauben, M4 x 20 mm (10)	Vis à tête plate, M4 x 20 mm (10)	Viti testa piana, M4x20 mm (10)
TLR241031	Body Posts & Tank Mount: 8X	Karosseriefposten und Tankhalterung: 8X	Poteaux de carrosserie et support de réservoir : 8X	Montanti carrozzeria e supporto serbatoio: 8X
TLR242052	Differential O-Rings, V2 (10): 8X	Differential O-Ringe, V2 (10): 8X	Joints toriques différentiels, V2 (10) : 8X	O-ring differenziale, V2 (10): 8X
TLR5933	Cap Head Screws, M3 x 12mm (10)	Inbusschrauben, M3 x 12 mm (10)	Vis d'assemblage creuses, M3x12 mm (10)	Viti testa cilindrica, M3x12 mm (10)
TLR242041	Wheel Hex, Front: 8XT	Sechskant, vorn: 8XT	Hexagone de roue avant : 8XT	Esagono ruota, Anteriore: 8XT
TLR243045	16mm Shock Nuts & O-rings (4): 8X	16 mm Dicht- und O-Ringe (4): 8X	Écrous d'amortisseur et joints toriques 16 mm (4) : 8X	O-ring e dadi amm. 16 mm (4): 8X
TLR242019	Spacer, Pinion Bearings (4): 8IGHT & 8T 4.0	Abstandhalter, Zahnradlager (4): 8IGHT & 8T 4.0	Entretoise, roulements à pignon (4) : 8IGHT et 8T 4.0	Distanziale, cuscinetti pignone (4): 8IGHT & 8T 4.0
TLR244055	Steering Link: 8X	Lenkstange: 8X	Tringlerie de direction : 8X	Tirante sterzo: 8X
TLR5903	Button Head Screws, M3 x 10mm (10)	Rundkopfschrauben, M3 x 10 mm (10)	Vis à tête bombée, M3 x 10 mm (10)	Viti testa tonda, M3x10 mm (10)
TLR5910	Button Head Screws, M3 x 14mm (10)	Rundkopfschrauben, M3 x 14 mm (10)	Vis à tête bombée, M3 x 14 mm (10)	Viti testa tonda, M3x14mm (10)
TLR5900	Button Head Screws, M3 x 5mm (10)	Rundkopfschrauben, M3 x 5 mm (10)	Vis à tête bombée, M3 x 5 mm (10)	Viti testa tonda, M3x5 mm (10)
TLR242044	Center Dogbone, Rear: 8XT	Mittiger Dogbone, Heck: 8XT	Dogbone central, arrière : 8XT	Cardano centrale, Posteriore: 8XT
TLR241067	Motor Mount w/Adapter: 8XT	Motorhalterung m. Adapter: 8XT	Support du moteur avec adaptateur : 8XT	Supporto motore con adattatore: 8XT
TLR244041	Sway Bar Set: 8X	Schwingen-Set: 8X	Ensemble de barre stabilisatrice : 8X	Kit barra antirollio: 8X
TLR5930	Cap Head Screws, M3 x 8mm (10)	Inbusschrauben, M3 x 8 mm (10)	Vis d'assemblage creuses, M3x8 mm (10)	Viti testa cilindrica, M3x8 mm (10)
TLR5961	Flathead Screws, M3 x 8mm (10)	Flachkopfschrauben, M3 x 8 mm (10)	Vis à tête plate, M3x8 mm (10)	Viti testa piana, M3x8 mm (10)
TLR241033	Front Bumper: 8X	Frontstoßstange: 8X	Pare-chocs avant : 8X	Paraurti anteriore: 8X
TLR243040	16mm Bleeder Shock Cap, Aluminum (2): 8X	16 mm Stoßdämpfer-Entlüfterkappe Aluminium (2): 8X	Capuchon d'amortisseur avec purgeur 16 mm, aluminium (2) : 8X	Tappi sfiato amm., 16 mm, alu (2): 8X
TLR244074	Shock Body, Rear(2): 8XT	Stoßdämpfergehäuse, Heck(2): 8XT	Carrosserie d'amortisseur, arrière (2) : 8XT	Corpo amm., posteriore (2): 8XT
TLR243024	X-Ring Seals (8), Lower Cap Seals (4): All 8IGHT	X-Ring Dichtungen (8), Stoßdämpfer-Endkappen unten (4): Alle 8IGHT	Joint torique X (8), Joints de couvercle inférieur (4) : 8IGHT (tout)	X-Ring (8), tenute tappo inf. (4): All 8IGHT
TLR241050	Steering Post (2): 8X	Lenksäule (2): 8X	Colonne de direction (2) : 8X	Montante sterzo (2): 8X
TLR242025	Front Gear Box: 8X	Vorderes Getriebegehäuse: 8X	Boîte à engrenage avant : 8X	Scatola ingranaggi anteriore: 8X
TLR245017	M4 Flanged Lock Nuts (10)	M4 Sicherungsmuttern mit Flansch (10)	Contre-écrous à collet M4 (10)	Dadi flangiati M4 (10)
TLR5965	Flathead Screw, M3 x 20mm (10)	Flachkopfschraube, M3 x 20mm (10)	Vis à tête plate, M3x20 mm (10)	Viti testa piana, M3x20 mm (10)
LOS252141	Front Ring & Pinion Gear: SLN	Vorderer Ring und Zahnradgetriebe: SLN	Anneau et engrenage à pignons avant : SLN	Pignone e corona anteriori: SLN
SPMS665	S665 - High Torque, steel gear 25T	S665 - Stahlgetriebe-Servo mit 25Z und hohem Drehmoment	S665 - Couple élevé, engrenages métalliques 25T	S665, coppia alta, ingr. acciaio 25T
LOS252142	Rear Ring & Pinion Gear: SLN	Hinterer Ring und Zahnradgetriebe: SLN	Anneau et engrenage à pignons arrière : SLN	Pignone e corona posteriori: SLN
LOS254078	Front Arm Set: SLN	Vorderer Querlenker: SLN	Ensemble de bras avant : SLN	Set braccio anteriore: SLN
LOS254075	Pin Mount Set: SLN	Bolzen-Montagesatz: SLN	Ensemble de support axe : SLN	Set supporto perni: SLN
LOS254076	Rear Hub: 8XE RTR	Hinterer Nabe: 8XE RTR	Moyeu arrière : 8XE RTR	Mozzo posteriore: 8XE RTR
LOS254077	Spindle Set: 8XE RTR	Spindelsatz: 8XE RTR	Jeu d'axes : 8XE RTR	Set alberino: 8XE RTR
LOS254082	Sway Bar Set: SLN	Schwingen-Set: SLN	Ensemble de barre stabilisatrice : SLN	Kit barra antirollio: SLN

SKU	English	Deutsch	French	Italiano
LOS254074	Pin Mount Cover Set: 8XE RTR	Abdeckungssatz Bolzen-Montage: 8XE RTR	Ensemble cache de support axe : 8XE RTR	Set coperchi montaggio perni: 8XE RTR
LOS254081	King Pin (4): 8XE RTR	Achsschenkelbolzen (4): 8XE RTR	Broche pivot (4) : 8XE RTR	Viti kingpin (4): 8XE RTR
LOS254079	Rear Arm Set: SLN	Hinterer Querlenker: SLN	Ensemble bras arrière : SLN	Set braccio posteriore: SLN
LOS253036	Rear Shock Shaft (2): SLN	Hintere Kolbenstange (2): SLN	Arbre d'amortisseur arrière (2) : SLN	Albero amm. post. (2): SLN
LOS253035	Front Shock Shaft (2): SLN	Vordere Kolbenstange (2): SLN	Arbre d'amortisseur avant (2) : SLN	Albero amm. ant. (2): SLN
SPMX-SE2130S	FIRMA 130 Sensored Brushless Smart ESC 2-4S	FIRMA 130 Sensored Brushless Smart Motorregler 2-4S	Variateur Smart ESC sans balais avec capteur FIRMA 130, 2 S - 4S	Smart ESC 2-4S FIRMA 130 Brushless con sensori
LOS-1243	Chassis Brace Set: 8XE RTR	Karosseriestrebensatz: 8XE RTR	Ensemble de support de carrosserie : 8XE RTR	Set bretella telaio: 8XE RTR
LOS-1244	Receiver & ESC Tray Set: 8XE RTR	Trägerplattensatz für Empfänger und Motorregler: 8XE RTR	Récepteur et support de variateur ESC : 8XE RTR	Set vassoio ESC e ricevitore: 8XE RTR
LOS-1297	Center Dogbone, 85.5mm, 8X 2.0, 8X RTR	Mittiger Dogbone, 85,5 mm, 8X 2,0, 8X RTR	Dogbone central, 85,5 mm, 8X 2.0, 8X RTR	Cardano centrale, 85,5 mm, 8X 2.0, 8X RTR
LOS-1433	Body, Screened: 8XTE RTR	Karosserie, lackiert: 8XTE RTR	Carrosserie, tramée : 8XTE RTR	Carrozzeria, schermata: 8XTE RTR
LOS-1434	Chassis: 8XTE RTR	Karosserie: 8XTE RTR	Carrosserie : 8XTE RTR	Telaio: 8XTE RTR
LOS-1435	Rear Dogbone Set: 8XTE RTR	Dogbone-Set hinten: 8XTE RTR	Ensemble dogbone arrière : 8XTE RTR	Set cardano posteriore: 8XTE RTR
LOS-1436	Rear Chassis Brace, Front Body Posts: 8XTE RTR	Hintere Karosseriestreben, vordere Gehäusestangen: 8XTE RTR	Support de carrosserie arrière, montants de coque avant : 8XTE RTR	Rinforzo post. telaio, supporto carrozzeria ant.: 8XTE RTR

## RECOMMENDED PARTS // EMPFOHLENE TEILE // PIÈCES RECOMMANDÉES // PEZZI RACCOMANDATI

No. parte	English	Deutsch	French	Italiano
DYNT2010	Machined Nut Driver Set (4) Metric	Set gefräste Steckschlüssel (4) metrisch	Ensemble tourne-écrou usiné (4) Métrique	Set di chiavi metriche (4)
DYNT2030	Machined Hex Driver Set (4) Met	Bearbeiteter Sechskantschlüssel-Satz (4) Met.	Ensemble clé à six pans usinée (4) Métrique	Set di chiavi a brugola metriche (4)
SPMX52S100H5	5000mAh 2S 7.4V SmartG2100C IC5	5000 mAh 2S 7,4 V SmartG2100C IC5	IC5 SmartG2100C 7,4 V 2 S 5000 mAh	5000 mAh 2S 7,4V Smart G2 100C IC5
SPMX53S100H5	5000mAh 3S 11.1V G2 100C HC IC5	5000mAh 3S 11,1 V G2 100C HC IC5	IC5 HC 100C G2 11,1 V 3 S 5000 mAh	5000 mAh 3S 11,1V G2 100C HC IC5
SPMX54S100H5	5000mAh 4S 14.8V SmartG2100C IC	5000 mAh 4S 14,8 V SmartG2100C IC	IC SmartG2100C 14,8V 4 S 5000 mAh	5000 mAh 4S 14,8V Smart G2 100C IC
SPMXC2040	Smart S1400 G2 AC Charger, 1x400	Smart S1400 G2 AC Ladegerät, 1x400	Chargeur c.a. Smart S1400 G2, 1 x 400	Caricabatterie SmartS1400 G2 AC1x400
SPM5025	DX5 Pro 2021 DSMR TX w/SR2100	DX5 Pro 2021 DSMR TX m. SR2100	Émetteur DSMR DX5 Pro 2021 avec SR2100	DX5 Pro 2021 DSMR TX con SR2100
SPMX54S50H5	5000mAh 4S 14.8V Smart G2 LiPo 50C Hard Case; IC5	5000mAh 4S 14.8V Smart G2 LiPo 50C Hardcase-LiPo-Akku; IC5	Li-Po 5 000 mAh 4S 14,8 V Smart G2 50C, boîtier, IC5	5000mAh 4S 14,8V Smart G2 LiPo 50C Hardcase; IC5
SPMXC2020	Smart S1200 G2 AC Charger; 1x200W	Smart S1200 G2 AC Ladegerät; 1x200W	Chargeur Smart CA S1200 G2, 1 x 200 W	Caricabatterie Smart S1200 G2 AC, 1x200 W
TLR74004	Silicone Shock Oil, 25WT, 250CST, 2OZ	Stoßdämpfer-Silikonöl, 25 WT, 250 cST, 2 oz. (59 ml)	Huile Silicone Pour Amortisseurs, 25WT, 250 CST, 59,15 ML (2 OZ)	Olio Silicone Amm, 25WT, 250CST, 2OZ
TLR75004	Silicone Diff Fluid, 100,000CS	Differential-Silikonflüssigkeit, 100.000CS	Liquide silicone pour différentiel, 100 000 CS	Fluido diff silicone, 100.000 CS
TLR75009	Silicone Diff Fluid, 500000CS	Differential-Silikonflüssigkeit, 500000CS	Liquide silicone pour différentiel, 500 000 CS	Fluido diff silicone, 500.000 CS

\* SPMXCA507 required to charge batteries with IC5 connectors on the S2100 Charger

\* Beim SPMXCA507 sind die Akkus mit IC5-Steckern am S2100-Ladegerät zu laden.

\* SPMXCA507 requis pour charger les batteries avec connecteurs IC5 sur le chargeur S2100

\* SPMXCA507 necessario per caricare batterie con connettori IC5 sul caricabatterie S2100

## OPTIONAL PARTS // OPTIONALE TEILE // PIÈCES OPTIONNELLES // PARTI OPZIONALI

No. parte	English	Deutsch	French	Italiano
LOS343200	12mm Machined Wheel Hex (4)	12 mm gefrästes Sechskantrad (4)	Écrou hexagonal de roue usiné de 12 mm (4)	Esagoni ruote lavorati 12 mm (4)
LOSA3575	1.0 Module Pitch Pinion, 15T	1.0 Modul Getrieberad, 15T	Pignon de pas module 1.0, 15 dents	Pignone passo modulo 1.0, 15T
LOSA3577	1.0 Module Pitch Pinion, 17T	1.0 Modul Getrieberad, 17T	Pignon de pas module 1.0, 17 dents	Pignone passo modulo 1.0, 17T
PRO278903	Vice CrushLock 2.6" Black/Black	Vice CrushLock 2,6" schwarz/schwarz	Vice CrushLock 2,6 po, noir/noir	Vice CrushLock 2.6" Nero/Nero
SPMXCA507	Adapter: IC3 Battery/IC5 Device	Adapter: IC3-Akku/IC5-Gerät	Adaptateur : Batterie IC3/dispositif IC5	Adattatore: IC3 batteria/IC5 dispositivo
TLR341008	Aluminum Servo Horn, 23T: 8X	Aluminium-Servohorn, 23T: 8X	Renvoi de commande du servo en aluminium, 23T : 8X	Squadretta servo alluminio, 23T: 8X
TLR5286	Silicone Diff Fluid, 50,000CS	Differential-Silikonflüssigkeit, 50.000CS	Liquide silicone pour différentiel, 50 000 CS	Fluido diff silicone, 50.000 CS
TLR5288	Silicone Diff Fluid, 125,000CS	Differential-Silikonflüssigkeit, 125.000CS	Liquide silicone pour différentiel, 125 000 CS	Fluido diff silicone, 125.000 CS
TLR74001	Silicone Shock Oil,17.5WT,150CST,2OZ	Stoßdämpfer-Silikonöl, 17,5 WT,150 cST, 2 oz. (59 ml)	Huile Silicone Pour Amortisseurs, 17.5WT,150 CST, 15 ML (2 OZ)	Olio Silicone Amm, 17,5WT, 150CST, 2OZ
TLR74002	Silicone Shock Oil,20WT,195CST,2OZ	Stoßdämpfer-Silikonöl, 20 WT, 195 cST, 2 oz. (59 ml)	Huile Silicone Pour Amortisseurs, 20 WT, 195 CST, 59,15 ML (2 OZ)	Olio Silicone Amm, 20WT, 195CST, 2OZ
TLR74003	Silicone Shock Oil,22.5WT,223CST,2OZ	Stoßdämpfer-Silikonöl, 22,5 WT, 223 cST, 2 oz. (59 ml)	Huile Silicone Pour Amortisseurs, 22,5 WT, 223 CST, 59,15 ML (2 OZ)	Olio Silicone Amm, 22.5WT, 223CST, 2OZ
TLR74005	Silicone Shock Oil,27.5WT,294CST,2OZ	Stoßdämpfer-Silikonöl, 27,5 WT, 294 cST, 2 oz. (59 ml)	Huile Silicone Pour Amortisseurs, 27,5 WT, 294 CST, 59,15 ML (2 OZ)	Olio Silicone Amm, 27.5WT, 294CST, 2OZ
TLR74006	Silicone Shock Oil,30WT,338CST,2OZ	Stoßdämpfer-Silikonöl, 30 WT, 338 cST, 2 oz. (59 ml)	Huile Silicone Pour Amortisseurs, 30 WT, 338 CST, 59,15 ML (2 OZ)	Olio Silicone Amm, 30WT, 338CST, 2OZ
TLR75008	Silicone Diff Fluid, 200000CS	Differential-Silikonflüssigkeit, 200000CS	Liquide silicone pour différentiel, 200 000 CS	Fluido diff silicone, 200.000CS
SPMSS6250	S6250 U-T / H-S Digital HV WP Servo	S6250 U-T / H-S Digitaler HV WP Servo	Servo numérique étanche haute tension U-T / H-S S6250	Servo digitale S6250 U-T/H-S HV WP
SPMSS6280	S6280 U-T / H-S Digital HV WP Servo	S6280 U-T / H-S Digitaler HV WP Servo	Servo numérique étanche haute tension U-T / H-S S6280	Servo digitale S6280 U-T/H-S HV WP
SPMSS6290	S6290 U-T / H-S Digital HV WP Servo	S6290 U-T / H-S Digitaler HV WP Servo	Servo numérique étanche haute tension U-T / H-S S6290	Servo digitale S6290 U-T/H-S HV WP
SPMR5025	DX5 Pro 2021 DSMR TX Only	DX5 Pro 2021 DSMR nur TX	DX5 Pro 2021 DSMR TX uniquement	Solo DX5 Pro 2021 DSMR TX
SPMR5115	DX5C SMART 5CH DSMR TX Only	DX5C SMART DSMR 5-Kanal nur TX	Émetteur DX5C SMART DSMR 5 Canaux Uniquement	SOLO DX5C SMART 5CH DSMR TX
SPMXC1010	Smart S2100 AC Charger, 2X100W	Smart S2100 AC Ladegerät, 2X100W	Chargeur c.a. Smart S2100, 2 x 100 W	Caricabatterie Smart S2100 AC 2x100 W
SPMXC1070	Smart S150 AC/DC Charger, 1x50W	Smart S150 AC/DC Ladegerät, 1x50W	Chargeur Smart c.a./c.c. S150, 1 x 50 W	Caricabatterie Smart S150 AC/DC 1x50 W
SPMXC2010	Smart S2200 G2 AC Charger,2x20	Smart S2200 G2 AC Ladegerät ,2x20	Chargeur Smart CA S2200 G2, 2 x 20	Caricabatterie Smart S2200 G2 AC 2x20
SPMX-50004S100H5	5000mAh 4S 14.8V Smart 100C; IC5	5000 mAh 4S 14,8 V Smart 100C, IC5	5 000 mAh 4S 14,8 V Smart 100C ; IC5	5000 mAh 4S 14,8V Smart 100C; IC5
SPMX-50004S50H5	5000mAh 4S 14.8V Smart 50C; IC5	5000 mAh 4S 14,8 V Smart 50C; IC5	5 000 mAh 4S 14,8 V Smart 50C ; IC5	5000 mAh 4S 14,8V Smart 50C; IC5
SPMX54S50H5	5000mAh 4S 14.8V Smart G2 50C;	5000mAh 4S 14,8V Smart G2 50C;	5000 mAh 4S 14,8 V Smart G2 50 C ;	5000 mAh 4S 14,8V Smart G2 50C;



**WWW.LOSI.COM**

©2024 Horizon Hobby, LLC.

Losi, 8IGHT XTE, DSM, DSM2, DSMR, IC5, Dynamite, Fuze, Prophet, Firma, DX3, and the Horizon Hobby logo are trademarks or registered trademarks of Horizon Hobby, LLC. The Spektrum trademark is used with permission of Bachmann Industries, Inc., and their respective logos are used under license by Horizon Hobby, LLC. All other trademarks, service marks and logos are property of their respective owners. US 9,320,977. US 10,528,060. US 9,930,567. US 10,419,970. Other patents pending.

Created 03/24

648789 | LOS04020